

PARTS LIST

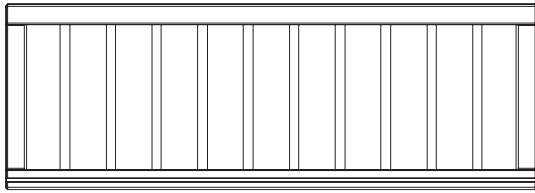

Crib side x 2

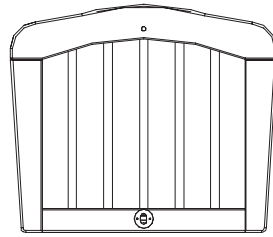

Crib end x 2
(one with key plate)



Wooden spacer x 2

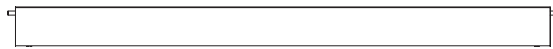

Crossbeam x 1

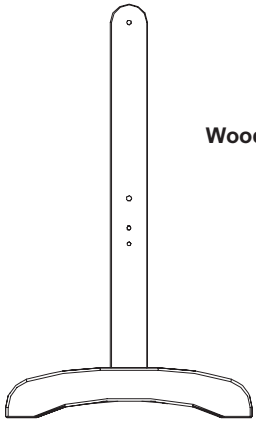

Leg x 2
(one with hole for stop peg)

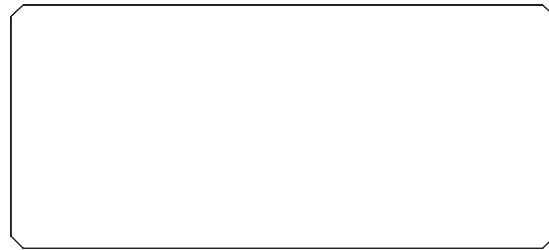

Crib base x 1



Pivot bolt x 2 (70mm)

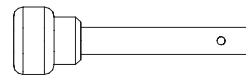

Stop peg x 1



Flat-headed bolt x 2 (50mm)



Bolt and nut
for stop peg

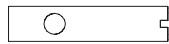

Cross dowel x 2



Flat-headed bolt x 8 (45mm)

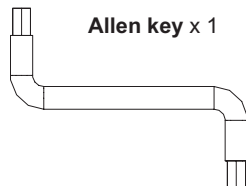

Allen key x 1



Barrel bolt x 2



Metal sleeve x 2



mothercare

SWINGING CRIB

IMPORTANT
RETAIN FOR FUTURE REFERENCE. READ CAREFULLY.

The illustrations used in these instructions are to be used as a guide only.

Conforms to British Standard BS EN 1130:1997

Made in Latvia for Mothercare UK Limited
Watford WD2 5SH

Tools required (not supplied): 1 x spanner or 1 x pair of pliers and 1 x screwdriver

SAFETY INSTRUCTIONS & WARNINGS

- The Swinging Crib is recommended for babies up to the point at which they can sit up unaided.
- When a child is able to sit, kneel or to pull itself up, the Crib shall not be used anymore for this child.
- The recommended mattress size for the Swinging Crib is 38 cm by 89 cm.
- The depth of the mattress shall not reduce the Crib side height above it to less than 20 cm (note indent on inside of Crib end).
- Always place the Crib on a flat, horizontal surface.
- Ensure that the Crib is kept away from heat sources such as electrical, gas, and open fires.
- Do not use the Swinging Crib if any part is broken or missing.
- Care should be taken that no screws or other fittings are loose, so your child cannot trap parts of the body or clothing (e.g., Strings, necklaces, ribbons for dummies), which would pose a risk of strangulation.
- Keep all hazards (knives, hot drinks, electrical flexes etc.) Out of reach of your baby.
- Keep children at a safe distance when assembling or disassembling the Crib.
- Young children should not be allowed to play unsupervised in the vicinity of the Swinging Crib.
- The Swinging Crib should be locked in the fixed position when the baby is unsupervised.
- Do not use the Crib without the stand.

MAINTENANCE

- Lubrication is not required on any part of the Crib.
- Check regularly to ensure that all the component are secure. Do not use the Crib if any parts are broken or missing.
- Store the Crib in a dry ventilated place when not in use.
- Only parts supplied by Mothercare UK Ltd. should be used.

BEFORE YOU START

- Remove all parts of the Crib from the packaging, and check against the parts list on the back of this instruction leaflet.
- 1 x Spanner or, 1 x Pair of Pliers and 1 x screwdriver.
- You will find it easier to assemble the Crib if a second adult is available to help you, especially at steps 3 and 4.

ASSEMBLY INSTRUCTIONS

1

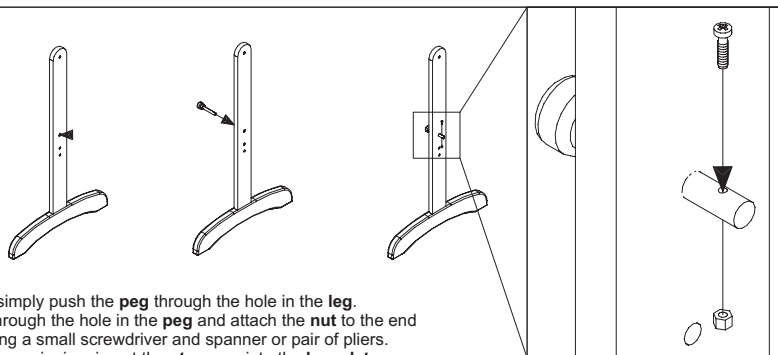

To use the **stop peg**, simply push the **peg** through the hole in the **leg**. Insert the small **bolt** through the hole in the **peg** and attach the **nut** to the end of the **bolt**. Tighten using a small screwdriver and spanner or pair of pliers. To prevent the **crib** from swinging, insert the **stop peg** into the **key plate** and turn one quarter turn left or right.
NOTE: for general safety, ensure that regular check are carried out to ensure the **nut** and **bolt** are tight in the **stop peg**.

ASSEMBLY INSTRUCTIONS - continued

2

Assembling the stand.

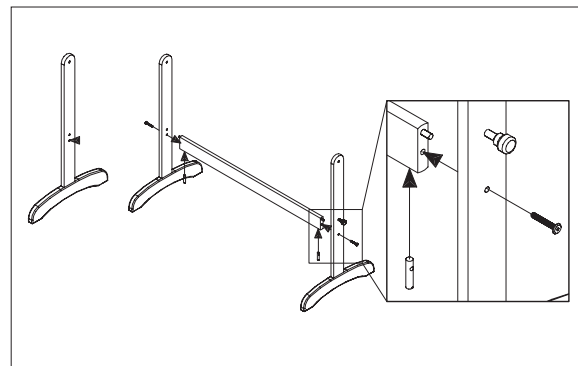

Insert the peg situated in one end of the **crossbeam** into the holes in one of the **legs** as shown. Thread a **M6x50 flat-headed bolt** through the bottom hole on the **leg** and into the **cross dowel** positioned into hole in the under edge of the **crossbeam**. Moderately tighten the **flat-headed bolt** with fingers only. Repeat to attach the other leg to the other end of the **crossbeam**.

3

Adding the base and completing the crib.

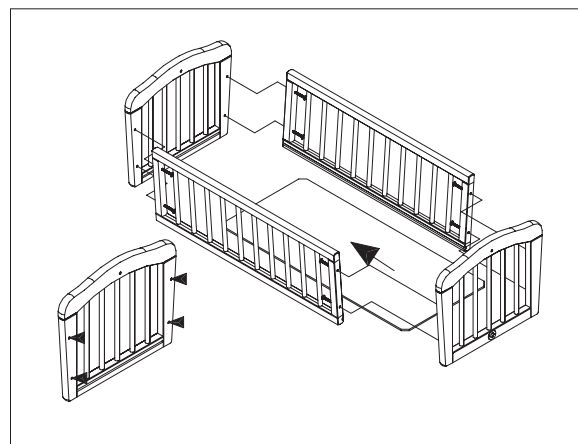

With the crib standing on its end, slide the **crib base** into the grooves in the **crib sides** and ensure that it locates securely into the groove in the **crib end**.

NOTE: The crib base should be label side up.

Attach the other **crib end** to the crib sides as in step 1, ensuring that the **crib base** locates into the groove.

Tighten all the **flat-headed bolts** 8 unit (**M6x45**) using the **Allen key** provided.

Put the crib assembly to one side for the moment.

4

Attaching the Crib to the stand.

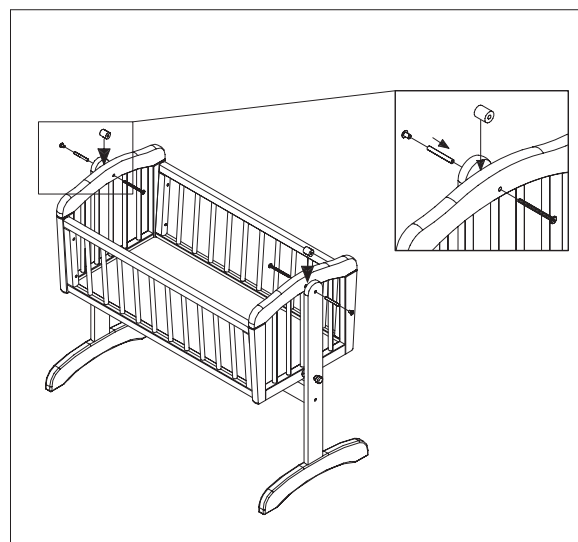

NOTE: Ensure crib end with key plate lines up with leg that has the hole for the stop peg.

Insert the **metal sleeve** into the middle hole at the top of one **crib end**, then through the **wooden washer**. Insert the **barrel bolt** into the hole in the top of the **leg**. Insert a **flat-headed bolt** part way into the **metal sleeve**. Lift the crib into position over the stand assembly (you may need assistance), and screw the **flat headed bolt** and the **barrel bolt** together, tightening with fingers.

Repeat at the other end.

TIGHTEN ALL THE BOLTS on the stand and crib using a screwdriver and the **Allen key** provided.

The **SWINGING CRIB** is now ready for use.