

care of your product

Periodically check all fittings to ensure that none have come loose.

The bed can be cleaned by wiping with a damp cloth and drying with a soft dry cloth.

Never clean with abrasive, ammonia based, bleach based, or spirit type cleaners.

Take care when handling or moving the bed.

Careless handling can damage wooden furniture.

safety notes

All Assembly fittings should be tightened properly and regularly checked for security.

Be aware of the risk of open fire and other sources of strong heat, such as electric bar fires, gas fires, etc. in the near vicinity of the wardrobe.

your child's safety is your responsibility

If you have a problem with this product or require replacement parts, please contact your nearest Mothercare store or telephone the Mothercare customer care line on **08453 30 40 30**

Alternatively write to:

Customer Care
Mothercare
Cherry Tree Road
Watford
Herts. WD24 6SH

www.mothercare.com



Pop Cabin Bed user guide

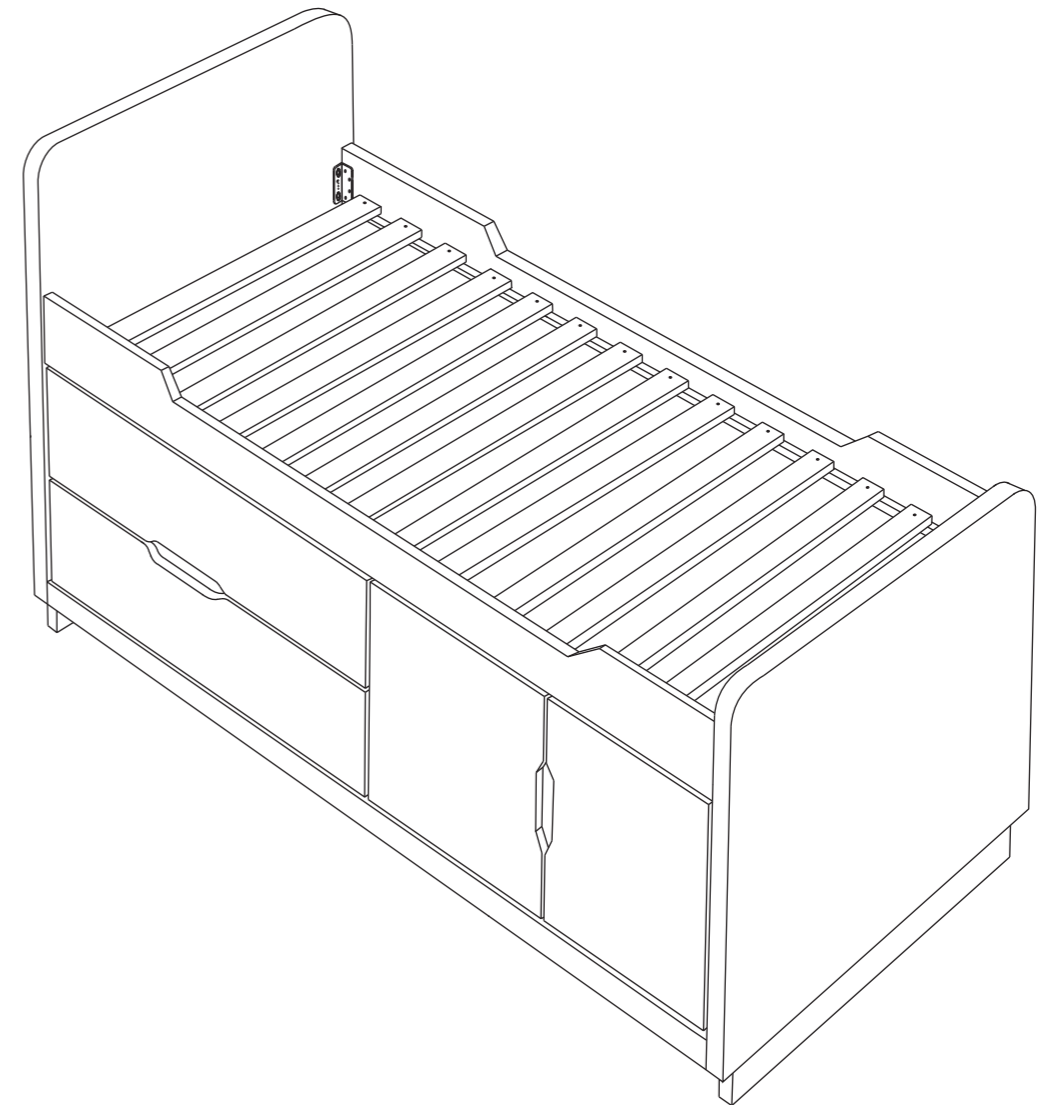

IMPORTANT - READ CAREFULLY AND KEEP FOR FUTURE REFERENCE

important notes

Please take a few minutes to read this user guide.
Lay the parts out on the floor and compare to the PARTS CHECK LIST (below). Do not discard any packaging until you are sure that you have all the parts.
You will need the aid of a second person at certain stages of assembly.

parts check list

fig 1.1 Large End	fig 1.2 Small End	fig 1.3 Back Board	fig 1.4 Middle Panel	fig 1.5 Plinth Block
fig 1.6 Base Panel	fig 1.7 Shelf	fig 1.11 Upper & Lower Drawer Fronts	fig 1.12 Drawer Bases	fig 1.8 Brace
fig 1.13 Front Plinth	fig 1.14 Mattress Base	fig 1.15 Drawer Backs	fig 1.16 Drawer Sides	fig 1.9 Foot
fig 1.19 25 Large Cams	fig 1.20 25 Large Cam pins	fig 1.17 Sides	fig 1.18 Drawer Runners	fig 1.10 Doors
fig 1.21 36 Large Dowels	fig 1.22 16 Short screws (10mm)	fig 1.23 2 Screw Bolts (50mm)	fig 1.24 6 Bolts (35mm)	fig 1.25 8 Bolts (16mm)
fig 1.27 1 Allen Key	fig 1.28 8 Small cams	fig 1.26 You need a cross-head screwdriver.	fig 1.32 34 Small Mattress Base screws	fig 1.33 4 Shelf studs
fig 1.29 8 Small cam pins	fig 1.30 4 Screw Bolts (40mm)	fig 1.31 4 Hinge sets	fig 1.34 4 Short screws (15mm)	

assembly

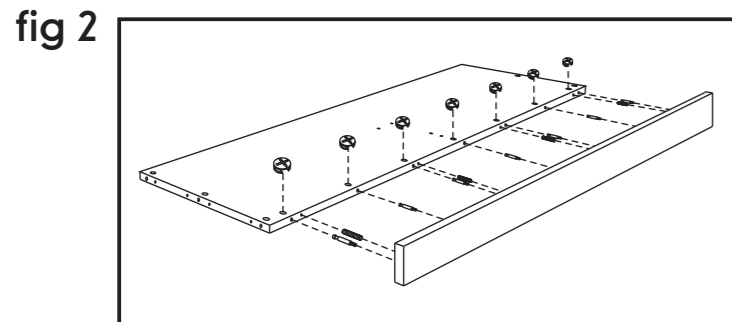

Attach the base panel to the front plinth by inserting 7 large cam pins and 4 dowels into the front plinth as shown. Also insert 7 large cams into the corresponding larger holes on the face of the base panel. Fit the two parts together by inserting the exposed ends of the large cam pins and dowels into the corresponding holes on the front edge of the base panel. Make sure that the arrows on the cams are pointing towards the heads of the cam pins. Once all cam pins and dowels are correctly engaged, tighten the cams clockwise to secure.

1

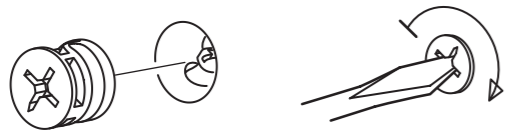

fig 12

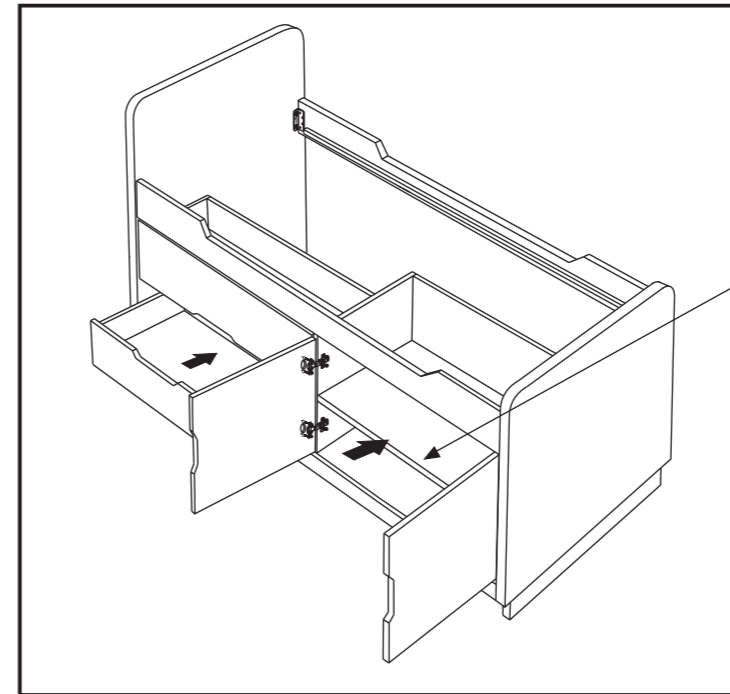

fig 12.1

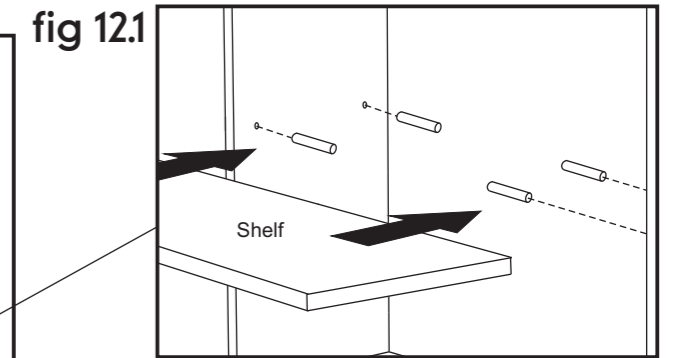
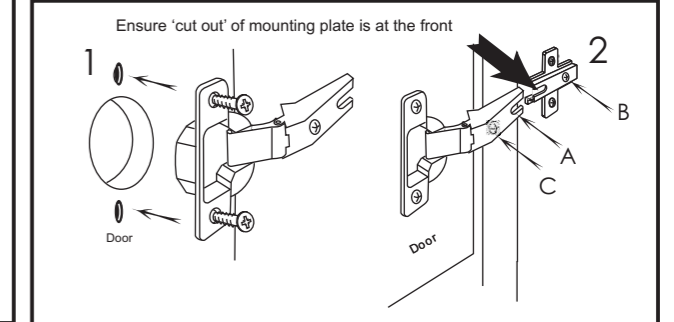

fig 12.2



Insert the 4 shelf studs into the holes on the inside faces of the carcass (see fig 12.1). Once the studs have been inserted into the correct position, carefully place the shelf into the unit. The shelf may need to be placed at an angle to ease insertion.

Attach the 4 mounting plates to the inside faces of the Carcass sides in the pre drilled pilot holes (as shown in fig 12.2).

Please note: The mounting plates should be orientated with the long edge or cut out section at the front.

1. Insert the door hinges into the large holes in the door and secure each with the 2 pre-fitted hinge screws (see fig 12.2).

2. To attach the door, fit hinge slot "A" under bolt "B" and tighten bolt "B".

Door adjustment may be made by slackening bolt "B" slightly and either tightening or loosening screw "C" as appropriate. Finally, re-tighten "B" and the screws holding the hinge mounts to the side panel.

fig 13

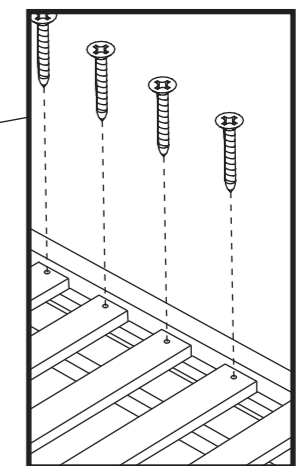
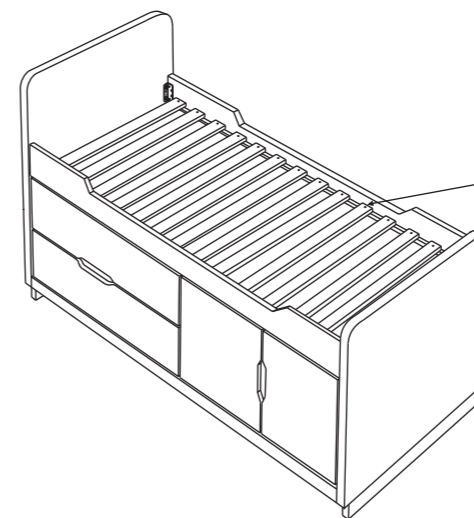

Carefully lift the mattress base onto the bed, webbing faced down, pull the mattress base up to one end, then spread that slats out evenly. Use the 34 small mattress base screws to secure the base to the bed through the holes in all slats.

6

fig 11

Screw 3 small cam pins and four dowels into each drawer front and place two drawer sides and one drawer brace onto each front ensuring that all cam pins are correctly engaged into their corresponding holes on the edges of each part (shown below). Fit 1 small cam pin into the smaller holes in the middle of each drawer back and 4 dowels into the holes in each end (shown below right). Also fit 1 dowel into each end of each drawer brace. Note: One drawer front is assembled with the 'cut out' handle facing upwards and the other facing downwards.

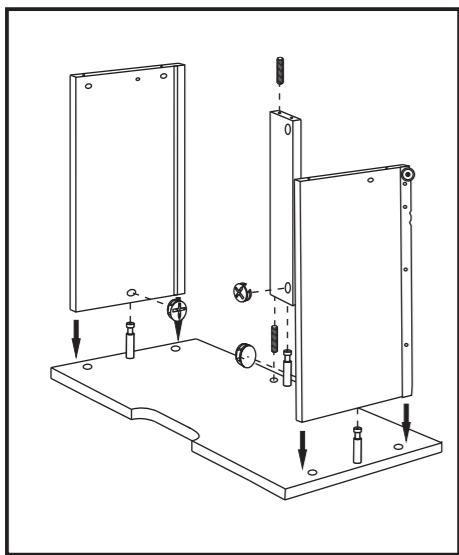

Once all is correctly aligned, insert 2 small cams into each drawer side and in the drawer brace then tighten the cams clockwise to secure the structure.

Note: do not fully tighten the cams until the whole drawer is assembled, this will make it easier to fit each drawer back

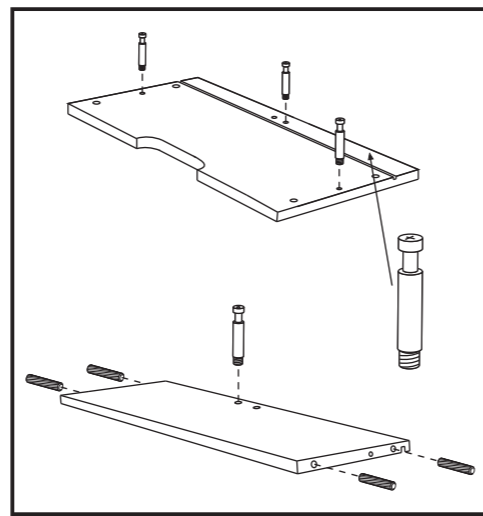

1. Insert the drawer base ensuring that it is correctly located into the grooves on the drawer sides. Slide the base down so that it also engages into the grooves on the drawer front.

2. Insert the drawer back by slightly leaning the drawer sides outwards. Ensure the dowels in the end of each drawer back locate into the corresponding holes on the inside face of each drawer side.

Note: The cams that attach the drawer fronts to the sides should be loosened to make it easier to fit the backs.

3. Use 2 screw bolts (40mm) and 1 small cam to fully attach the back and secure the construction of each drawer.

Make sure that all drawer cams are rotated clockwise and fully tightened.

Complete stages below 1 to 3 for both Drawers

Finally, place each drawer into the main assembly, ensuring that the pre-fitted drawer runner mechanisms engage correctly (See fig 12).

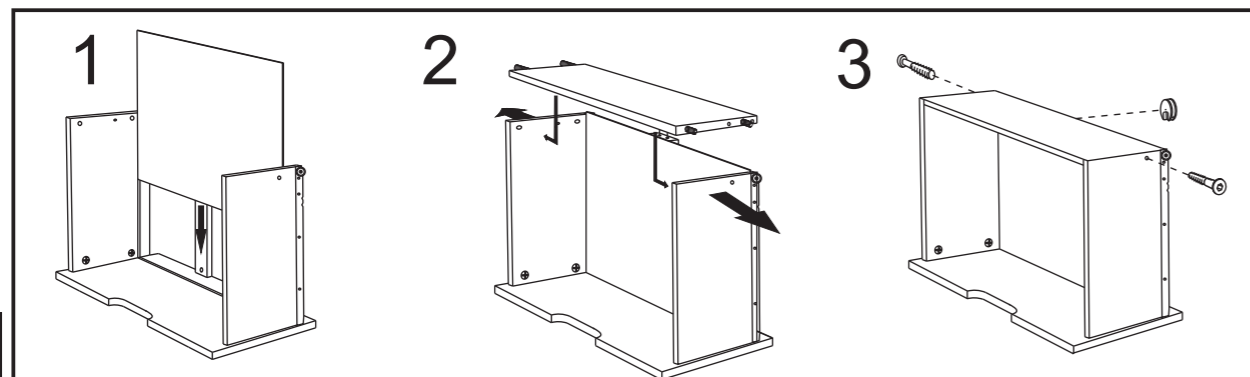

5

fig 3

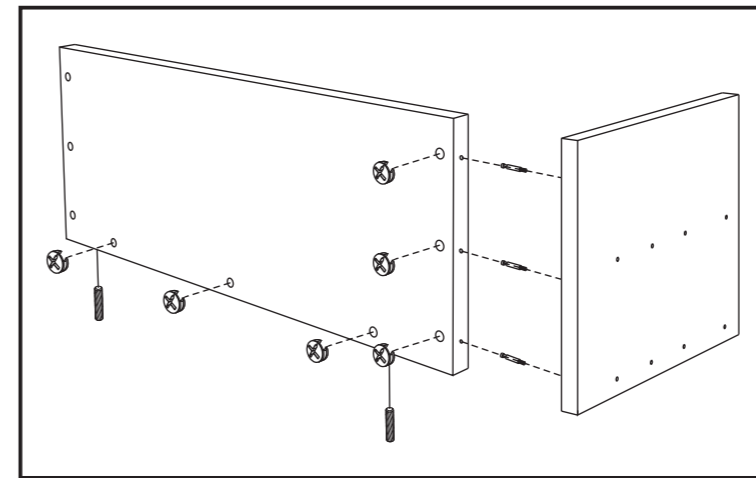

Attach the middle panel to the back board by inserting 3 large cam pins into the three small parallel holes on one side of the middle panel as shown left. Insert 6 large cams into the large holes on one face of the back board. Attach the two components together as shown and tighten the three cams clockwise to secure. Also insert 2 dowels into holes in the underside edge of the back board.

fig 4

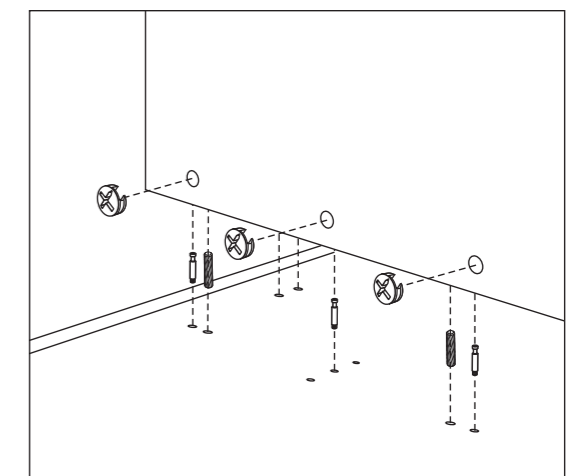
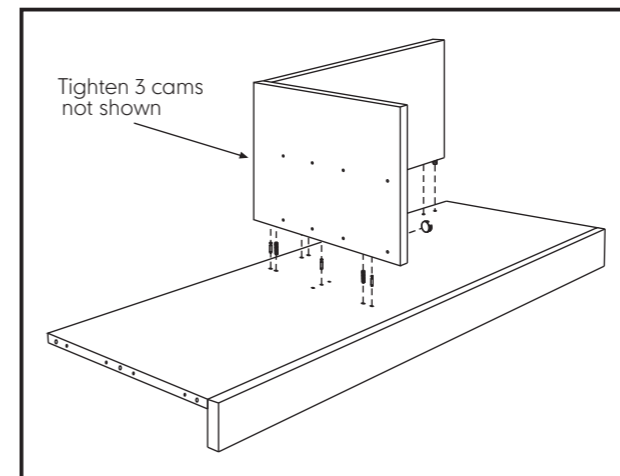

Fit 6 large cam pins and 2 dowels into the upper face of the base panel, also fit 3 large cams into the large holes on the inside face of the middle panel. Carefully lower the subassembly of the back board and middle panel onto the base panel, ensuring that all corresponding cam pins and dowels engage correctly. Once in position, tighten all cams clockwise to fix the two sub assemblies together.

fig 5

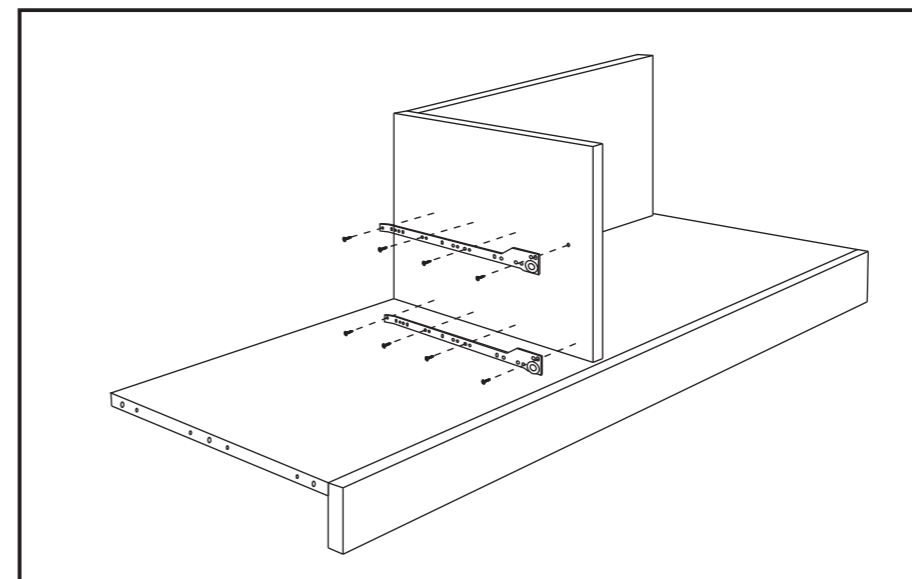

Attach the 2 right hand drawer runners to the left side of the middle panel using 8 short screws (10mm) as shown right.

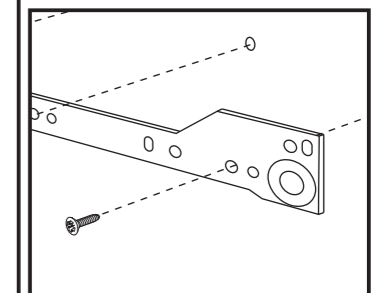

Runner hole location detail as above.

2

fig 6

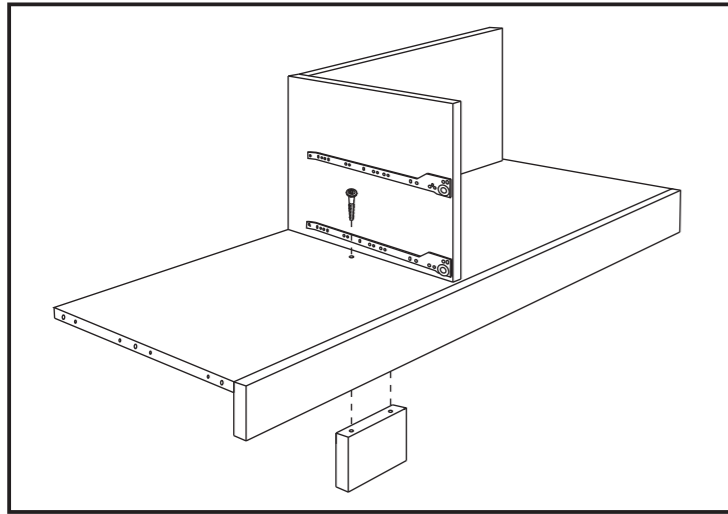

Attach the foot to the underside of the base panel using 2 screw bolts (50mm) as shown left.

fig 7

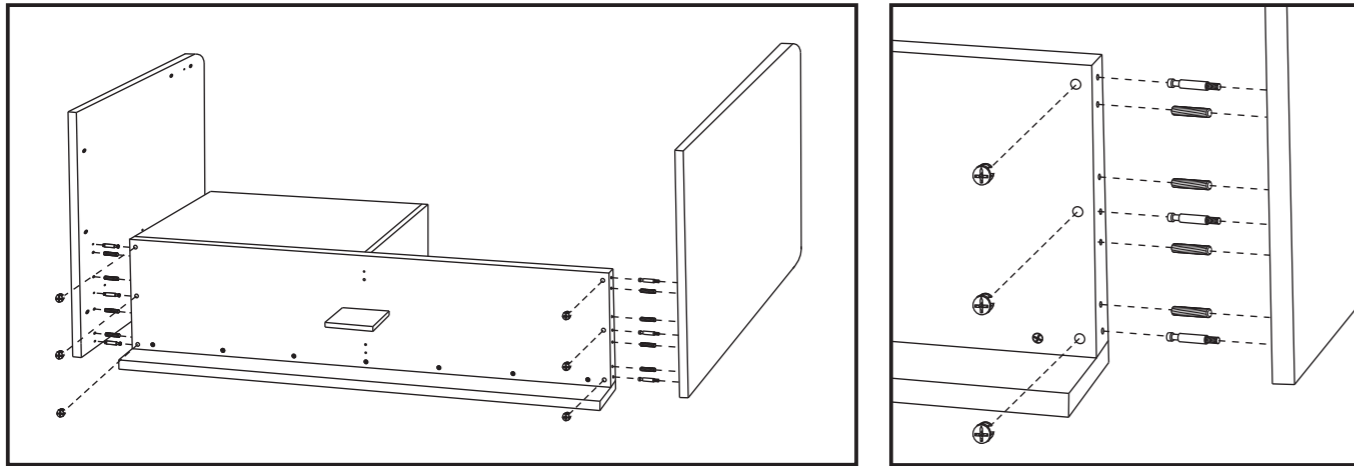

Attach both the large and small end to the assembly using 6 large cam pins, 6 large cams and 8 dowels as shown above.

fig 8

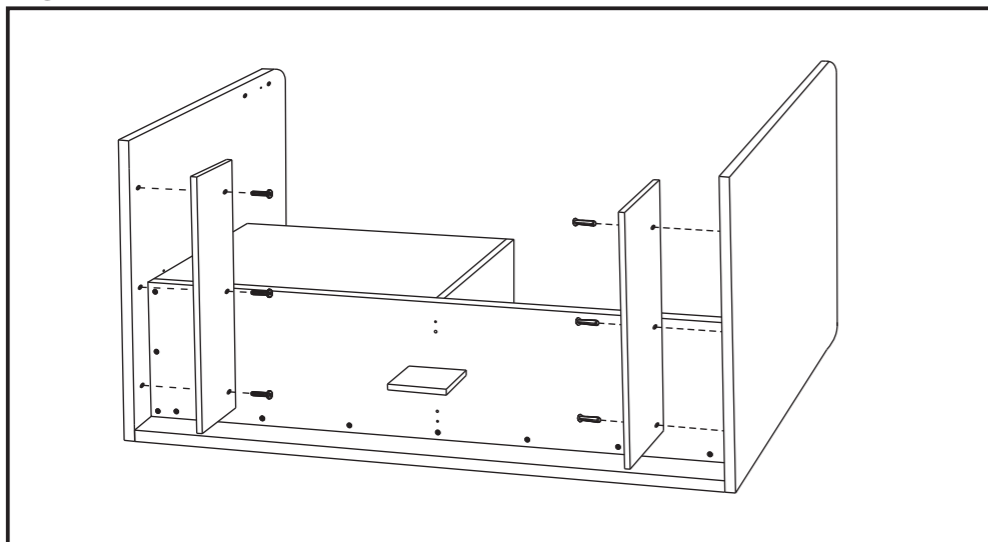

Attach the 2 plinth blocks to the inside faces of both ends using 6 (35mm) bolts as shown left.

fig 9

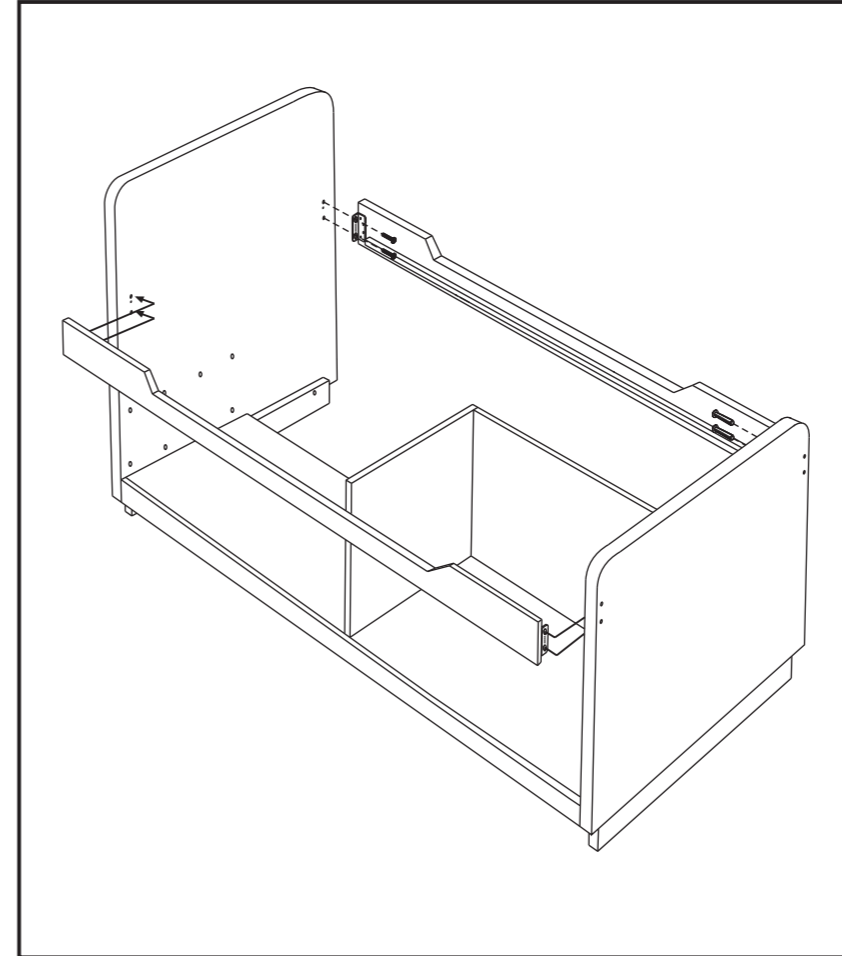

Insert 4 bolts (16mm) into each of the pre-fitted metal inserts in each end. Ensure the bolts are only screwed in half way so that they are easier to locate onto the brackets. Slide brackets downwards to engage onto bolts. Tighten the bolts to secure the product.

fig 9.1

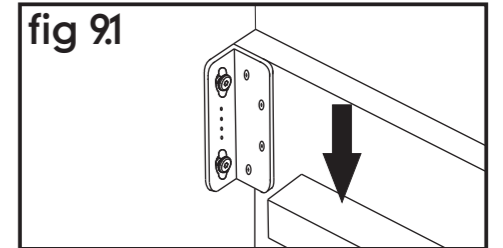
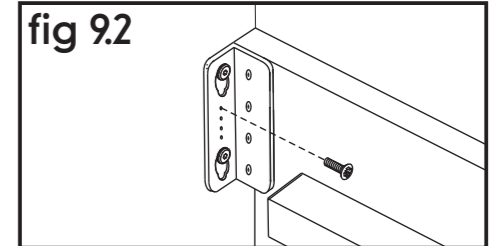
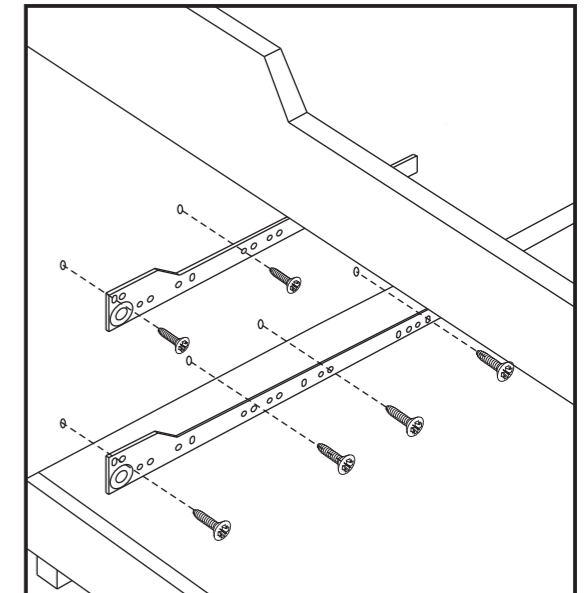
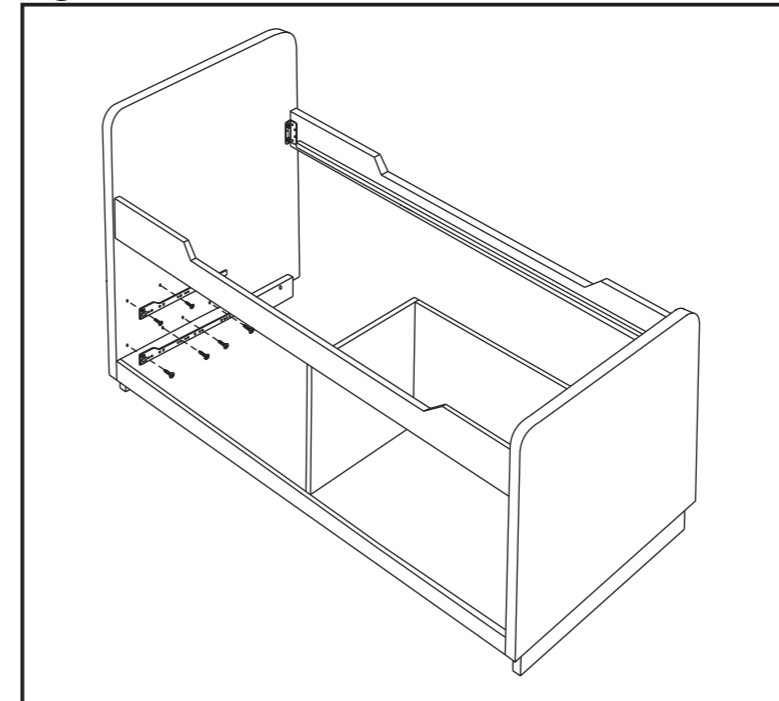

fig 9.2



Finally, fit 1 short screw (15mm) into the upper smaller hole on each bracket as shown in fig 9.2.

fig 10



Attach the 2 remaining drawer runners to the inside face of the large end using the 8 remaining short screws (10mm). Please refer to fig 5 for more detailed information regarding the position of screws through the holes in the runner.