

mothercare

Your Child's Safety Is Your Responsibility

If you have a problem with this product or
require replacement parts, please contact
your nearest Mothercare store or telephone
the Mothercare Customer Care Line on
01923 210 210

Alternatively write to:

Customer Care
Mothercare
Cherry Tree Road
Watford
Herts. WD2 5SH



Child's Slatted Bed

User Guide

IMPORTANT. RETAIN FOR
FUTURE REFERENCE -
READ CAREFULLY

1. Checklist

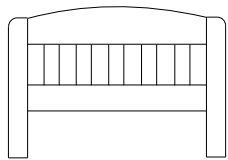

2 ends

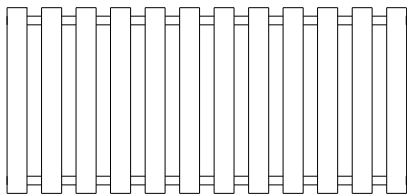

1 set mattress slats

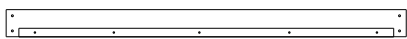

2 Mattress Rails



8 Long Bolts



6 screws



8 Barrel Nuts

2. Putting the Bed Together

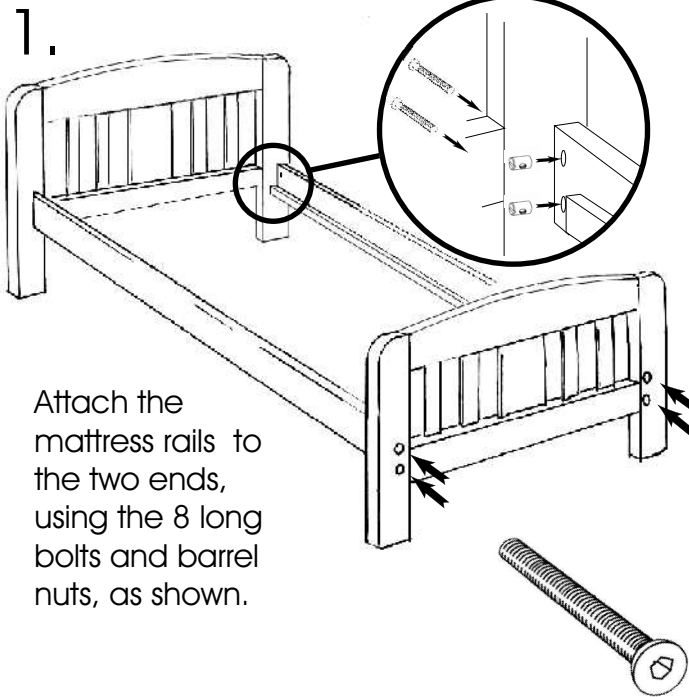

Attach the mattress rails to the two ends, using the 8 long bolts and barrel nuts, as shown.

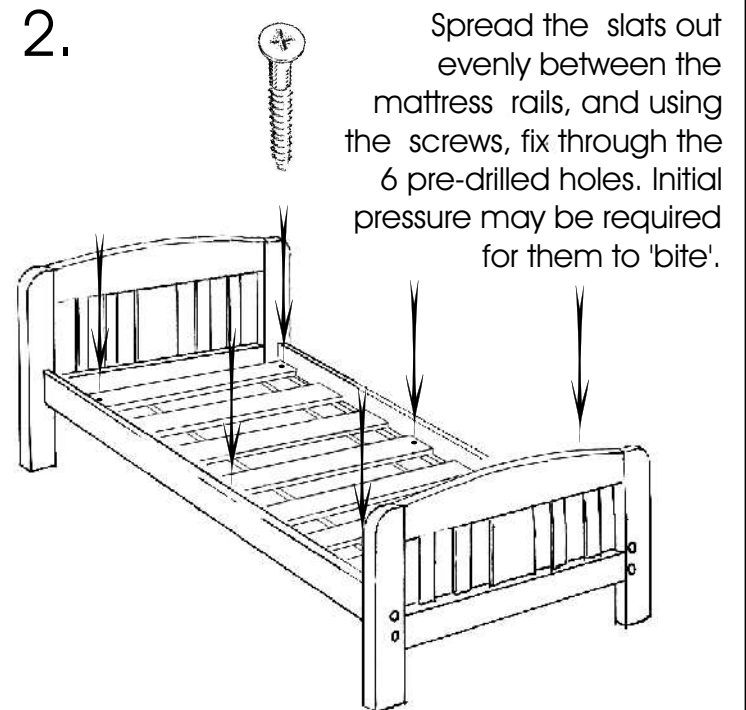

Spread the slats out evenly between the mattress rails, and using the screws, fix through the 6 pre-drilled holes. Initial pressure may be required for them to 'bite'.

3. Care and Safety

- Periodically check all fittings to ensure that none have come loose.
- The bed must be set up on an even and stable surface.
- Clean your bed by wiping with a damp cloth & drying with a soft cloth.
- Never clean with abrasives, chemical cleaners or household polishes.
- Keep away from direct sources of heat, such as electric, gas or coal fires.
- Take care when handling or moving the bed. Careless handling can damage wooden furniture.
- Bouncing on, or using this bed other than for its intended purpose, could cause damage to the structure or serious injury to your child.

MATTRESS SIZE: The recommended mattress to be used with this bed should measure 190cm x 74cm (6'3" x 2'6")