



**REBEL**

**PRO**



**INSTRUCTIONS**

*español* 11

*english* 14

*français* 17

*deutsch* 20

*italiano* 23

*português* 26

*nederlands* 29

*norsk* 32

*türkçe* 35

ΕΛΛΑΝΙΚΑ 38

РУССКИЙ 41

*polski* 44

**E** ACCESORIOS

**GB** ACCESSORIES

**F** ACCESSOIRES

**D** ZUBEHÖR

**I** ACCESSORI

**P** ACESSÓRIOS

**B** ACCESSOIRES

**NK** TILBEHØR

**TR** AKSESUARLAR

**GR** ΕΞΑΡΤΗΜΑΤΑ

**RU** АКЦЕССУАРЫ

**PL** AKCESORIA



CUBREPIES - APRON  
COUVRE-PIEDS - BEINABDECKUNG  
COPRIGAMBE - COBRE-PÉS  
VOETDEKJE - FOTDEKKE  
ÖNLÜK - ΚΑΛΥΜΜΑ ΠΟΔΙΩΝ

Покрывало для ног - OKRYCIE NA NÓŻKI



CONJUNTO LLUVIA - RAIN COVER  
ENSEMBLE PLUIE - REGENSCHUTZ  
CAPOTTINA PARAPIOGGIA - CONJUNTO CHUVA  
REGENHOES - REGNKAPPE  
YAĞMURLUK - ΔΙΑΒΡΟΧΟ ΚΑΛΥΜΜΑ

Защита от дождя - KOMPLET PRZECIWDWESZCZOWY



MOSQUITERA - MOSQUITO NET  
MOUSTIQUAIRE - FLIEGENNETZ  
ZANZARIERA - MOSQUITEIRO  
MUSKIETENGAAS - MYGGNETT  
SINEKLIK - ΚΟΥΝΟΥΠΙΕΡΑ

Защита от комаров - MOSKITERA

## PART LIST

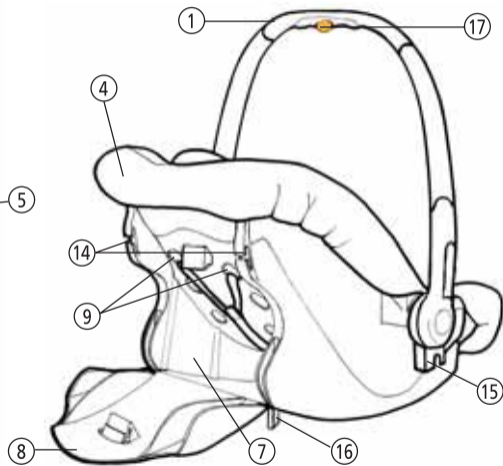

## PART LIST

### ESPAÑOL

- 1- ASA DE TRANSPORTE
- 2- TIRADOR ASA
- 3- CARCASA REBEL PRO
- 4- TAPIZADO EXTRAÍBLE
- 5- REDUCTOR
- 6- CINTA DE HOMBROS
- 7- COMPARTIMENTO PORTAOBJETOS
- 8- TAPA COMPARTIMENTO PORTAOBJETOS
- 9- AJUSTE CINTA DE HOMBROS
- 10- HEBILLA ENTREPIERNAS
- 11- TENSOR CINTA DE HOMBROS
- 12- LIBERADOR CINTA DE HOMBROS
- 13- PASOS DELANTEROS CINTURÓN SEGURIDAD
- 14- PASOS POSTERIORES CINTURÓN SEGURIDAD
- 15- ACOPLER PRO FIX
- 16- ESTABILIZADORES TRASEROS
- 17- PULSADOR ASA

### ENGLISH

- 1- CARRY HANDLE
- 2- HANDLE LEVER
- 3- SHELL WITH ROCKER
- 4- REMOVABLE COVER
- 5- REDUCER
- 6- SHOULDER PADDING
- 7- STORAGE COMPARTMENT
- 8- STORAGE COMPARTMENT LID
- 9- SHOULDER STRAP ADJUSTMENT
- 10- BUCKLE BETWEEN LEGS
- 11- SHOULDER STRAP TIGHTENER
- 12- SHOULDER STRAP RELEASE
- 13- SAFETY BELT FRONT OPENINGS
- 14- SAFETY BELT REAR OPENINGS
- 15- PRO FIX SYSTEM
- 16- REAR STABILISERS
- 17- HANDLE SWITCH

### FRANÇAIS

- 1- ANSE DE TRANSPORT
- 2- TIRETTE ANSE
- 3- CARCASSE À BALANCEMENT
- 4- REVÊTEMENT AMOVIBLE
- 5- RÉDUCTEUR
- 6- MATELASSAGE ÉPAULES
- 7- COMPARTIMENT FOURRE-TOUT
- 8- COUVERCLE COMPARTIMENT FOURRE-TOUT
- 9- RÉGLAGE SANGLE PAR ÉPAULES
- 10- BOUCLE ENTREJAMBES
- 11- TENDEUR SANGLE ÉPAULES
- 12- LIBÉRATEUR SANGLE ÉPAULES
- 13- PASSAGES AVANT CEINTURE DE SÉCURITÉ
- 14- PASSAGES ARRIÈRE CEINTURE DE SÉCURITÉ
- 15- SYSTÈME PRO FIX
- 16- STABILISATEURS ARRIÈRE
- 17- POUSSOIR ANSE

### DEUTSCH

- 1- TRANSPORTBÜGEL
- 2- BÜGELKLINKE
- 3- SCHAUKELSCHALE
- 4- HERAUSNEHMBARE POLSTEREINLAGE
- 5- REDUZIERSTÜCK
- 6- SCHULTERPOLSTERUNG
- 7- ABLAGEFACH
- 8- VERSCHLUSS
- 9- SCHULTERGURTEINSTELLUNG
- 10- BEINSCHNALLE
- 11- SCHULTERGURTSPANNER
- 12- SCHULTERGURTÖFFNER
- 13- GURTSCHLAUFEN VORNE
- 14- GURTSCHLAUFEN HINTEN
- 15- PRO-FIX-SYSTEM
- 16- RÜCKWÄRTIGE STABILISATOREN
- 17- BÜGELKNOPF

6



7



8

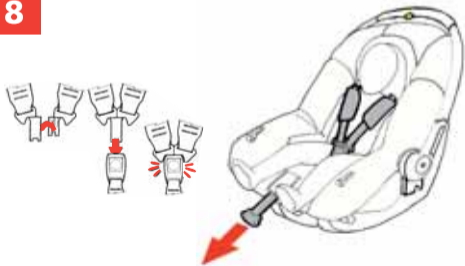

9



10

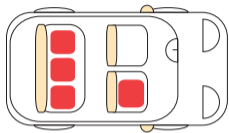

11



12

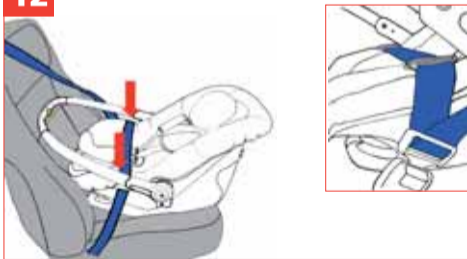

13



## ENGLISH

### YOUR REBEL PRO

Your new REBEL PRO by Jané is a baby-carrier designed to protect your baby in the car, from when they are born until they reach a maximum weight of 13 Kg. (European Directive ECE 44/3 Group 0+).

You can also use the REBEL PRO with any other JANÉ chassis that has the PRO FIX fastening system.

### HANDLE POSITIONS

- 1 -The handle (-1-) on your REBEL PRO has 3 positions:  
A1—Horizontal.  
A2—Carrying your baby.  
A3—Car position.
- 2 -To change the position, push the lever (-2-) and move the handle (-1-) to the desired position.

### FASTENING TO A JANÉ, S.A. CHASSIS (PRO-FIX SYSTEM)

- 3 -To fasten your REBEL PRO to the chassis, insert the connections (15) in the chassis cavity and press until you hear a "click".
- 4 -Press the handle button (17) and pull upwards to release your REBEL PRO from the chassis.

### ROCKING LIMITER

- 5 -Open the carry compartment lid (8) and slide the stabiliser down to lock it.

### GROUP 0+ SAFETY BABY-CARRIER

- 6 -Make your baby comfortable and find the two grooves nearest to their shoulders.
- 7 -Open the strap compartment lid (8) and pass the shoulder straps (6) and their corresponding protectors through the correct grooves, as in Figure 6.
- 8 -Fasten the shoulder straps (6) with the buckle between the legs (10) and pull the tightening strap (11) making everything both firmly fastened and comfortable.
- 9 -To loosen the tension of the harnesses, press the button (12) as you pull the shoulder straps (6) as shown in the figure.
- 10 -Decide the location of your REBEL PRO in the car (one of the four possible ones), providing that you have a seat belt with three fastening points and that it is not a front seat with an activated front AIRBAG.

- 11 - Place the handle (-1-) in position A3 (car). You will see two orange triangles lined up.
- 12 - Place your REBEL PRO in the location you have chosen as explained in the figure. Pass the abdominal part of the seat belt through the front openings (13) and fasten the seat belt.
- 13 - Now pass the diagonal part of the seat belt through the rear openings (18). All the openings are marked in blue.

Ensure that the car seat belts hold the REBEL PRO perfectly and that the harness is correctly taut, making visual checks throughout your journey.

If you notice that the car seat belts are not sufficient to hold your REBEL PRO, you can adjust the following parameters to improve this:

- Redine the backrest of the car seat a little.
- Move the car seat back a little.
- Adjust the seat belt height regulators to the lowest position.

## WARNING

- Always remember to carry your baby with the safety harnesses correctly fastened.
- The REBEL PRO baby-carrier can also be used in conjunction with other families of JANÉ, S.A. pushchair chassis.
- It is very important that you always use all components that bear the original JANÉ, S.A. trademark. It may be highly dangerous if you use accessories that are not authorised by the manufacturer.
- Any changes or additions to the device without the correct authorisation from JANE, S.A. may seriously affect the safety restraining system.
- Failure to follow the instructions carefully for the correct use of the restraining system may be dangerous for your baby's safety.

- Keep this instruction book for future reference.
- Inside the car, ensure that both your luggage and any other object which may cause harm should an accident occur are correctly fastened or packed away.
- The REBEL PRO baby-carrier must be fastened correctly with the safety belts, even when it is not in use, as should an accident occur it may be thrown about and harm the occupants of the vehicle.
- Never under any circumstances carry your baby in your arms or out of the baby-carrier when you are in the car. Although it may seem strange, the impact caused by an accident at only 40 km/h will make it completely impossible to restrain your baby correctly.
- Never leave your child on their own.

## MAINTENANCE

Wash the plastic parts in warm soapy water. Afterwards, carefully dry all the components.

The cover can easily be removed for washing.

Wash by hand and at a temperature never above 30° C. Dry naturally in a shaded place.

Prolonged exposure of the cover to sunlight may affect the stability of the fabric colour.

Your REBEL PRO baby-carrier has a guarantee with precise specifications on how to maintain it correctly, which is important to keep them fully valid.

If you suffer a violent accident, we recommend that you replace your REBEL PRO restraining system with a new one.

If you have any doubts, always contact your specialist supplier or contact our customer care service (SPAIN Tel. 902500800).





**JANÉ, S.A.** Pol. Industrial Riera de Caldes  
C/ Mercaders, 34 - 08184 Palau Solità i Plegamans. BARCELONA  
Telf. 93 703 18 00 - Fax: 93 703 18 04 [www.jane.es](http://www.jane.es)



IM-412