

impression moulding & sculpting kit

instructions for use

Please read carefully before use. All “Fig” references in this guide refer to the illustrations in the English section.

- This product is not a toy and must be used by an adult or child under adult supervision.
- Test the clay on your child’s wrist before use. In the unlikely event of skin irritation, discontinue use.
- Clay will harden and dry at room temperature. Do not place the clay in the oven to dry out.
- Do not close the frame until the clay has fully dried. Moisture in the clay when the frame is closed may cause mould to form on the impression.
- Mothercare recommends that during creative activities, clothes, carpets and furniture are protected.
- When cleaning remove the excess clay and leave it to dry. On carpets, use a stiff brush and loosen the remaining attached clay and then vacuum clean. If necessary wash with gentle soap and cold water. Do not use hot water or cleaning solutions.
- This product is non-toxic.

equipment required but not supplied

One large wide mixing bowl.

Step 1- First decide if you are going to prepare a 2D or a 3D impression. The 3D impression produces more of a multidimensional effect. The impression will make approximately 2x2D impressions and one 3D impression depending on the size of the subjects hand or foot (see Fig 1).

Step 2- To create the 2D impression take 180mls or 3 scoops of pink powder and place in a wide mixing bowl. Add 280mls of water to the pink powder and mix thoroughly until a paste forms. Quickly take the hand or foot of the subject you are going to mould and very quickly place it into the paste until half of the hand or foot is submerged in the impression material. Make sure it is deep enough so that you will be able to produce a realistic looking hand or foot impression. Please make sure that the hand or foot is not touching the bottom or sides of the container otherwise the end result will be affected (see Fig 2).

Step 3- Once you have placed the hand or foot in position. Leave it to set for approximately 3-4 minutes or until the material is spongy to the touch. As soon as this happens ease the hand or foot out of the impression material – this should be very easy and only a small amount of pressure is required. To create a 3D mould follow the steps above you will need to use 4 scoop or 240mls of powder and 420mls or 7 scoops of water. As soon as you have mixed the paste quickly pour into the cardboard container supplied.

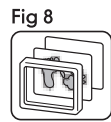
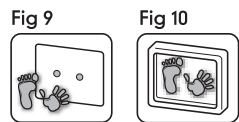
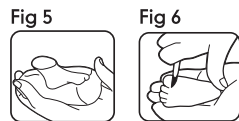
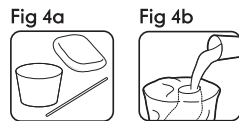

This should be deep enough for you to fully submerge the child's hand or foot. Then continue as above.

Step 4- Clean all utensils before you start this process. Take the plaster powder and using the measuring scoops and place 240mls or 4 scoops of plaster into the bowl and add 2 scoops of water or 120mls mix thoroughly until it forms into a smooth paste. Pour the plaster carefully into the mould trying to avoid any air bubbles. Leave to dry about 2-3 hours or until completely firm or dry to the touch (see Fig 4a & 4b).

Step 5- You can then remove the whole project from the mixing bowl/cardboard box and start to remove the pink jelly like impression material from the plaster mould. You should remove all of the pink material (see Fig 5).

Step 6- To create a smooth surface on the rear of the plaster mould, use the smoothing tool as shown to eliminate any lumps. This will help when attaching the foot or hand to the mount card (see Fig 6).

Step 7- Select your preferred colour of paint either pewter or gold. Use the paint brush to apply a light coat of colour to your moulding and allow to dry completely before moving to stage 8 (see Fig 7).

Step 8- Unscrew the rear of the frame – you will find an insert border and a mount card. The insert border should be placed behind the glass. Take the mount card and decide the best position for your moulding – take the double sided pads and peel off the backing and place the sticky side onto the smooth rear side of the hand or foot (see Fig 8).

Step 9- Remove the protective cover from the sticky pads and press the hand or foot firmly into place onto the mount card (see Fig 9).

Step 10- Close the frame using a screw driver and there you have your finished impression moulding and sculpting project (see Fig 10).

Please keep a note of our company name and address.

Dispose of all packaging safely.

Made exclusively for Mothercare, Watford, England, WD24 6SH.