

mothercare

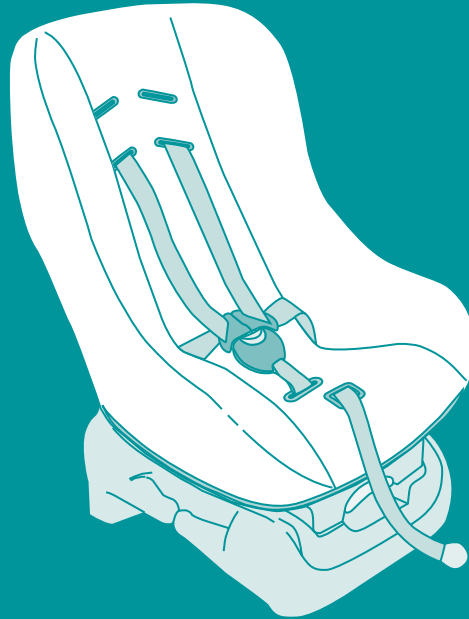

Daytona Car Seat

User Guide

IMPORTANT

Please retain this User Guide for future reference.

Conforms to
ECE R44.03
Universal

EXTREME HAZARD: Parents should not under any circumstances use this child restraint on a passenger seat equipped with an airbag.

Safety warnings

- PLEASE READ THOROUGHLY BEFORE COMMENCING INSTALLATION AS AN INCORRECT INSTALLATION COULD BE DANGEROUS.
- DO NOT USE THIS CHILD SEAT IN PASSENGER SEATS EQUIPPED WITH AIRBAGS.
- This child seat can only be installed in a forward facing position. Do not use on side facing or rear facing seats.
- Never use this child seat without fastening the child's harness correctly, and never attempt to use it without fastening it into the car as described in these instructions.
- When using the child seat, it is most important that the car seat belt is correctly routed. Ensure the belt straps are not kinked.
- The child seat must be tightened down on the upholstery as tight as possible to ensure maximum protection. The recommended method is shown in these instructions.
- Do not add to or modify the seat in any way.
- It is recommended that this car seat should be changed when it has been subjected to violent stresses in an accident or has become badly worn. Periodically inspect the harness for wear, paying particular attention to the attachment points, stitching and adjusting devices.
- Do not leave your child unattended in the seat at any time.
- Ensure that no part of the seat is trapped in a door or folding seat. If your car has a folding rear seat, ensure that it is correctly latched in the upright position.
- Car interiors can become very hot when in direct sunlight, it is therefore recommended that the child seat is covered when not in use. This prevents components, particularly those attached to the child seat, becoming hot and burning the child.
- In the event of an emergency it is important that the child can be released quickly. This means that the buckle is not fully tamper-proof and so your child must be taught never to play with the buckle.
- Luggage and other heavy or sharp objects should be secured in the car. Loose objects are liable to cause injury in the event of an accident.
- The safest seating position for a child's car seat is on the rear seat of a vehicle.

Getting to know your child seat

This seat is classified as Group1 for children weighing 9kg to 18kg (9 months-4years approx.) - in a forward facing position.

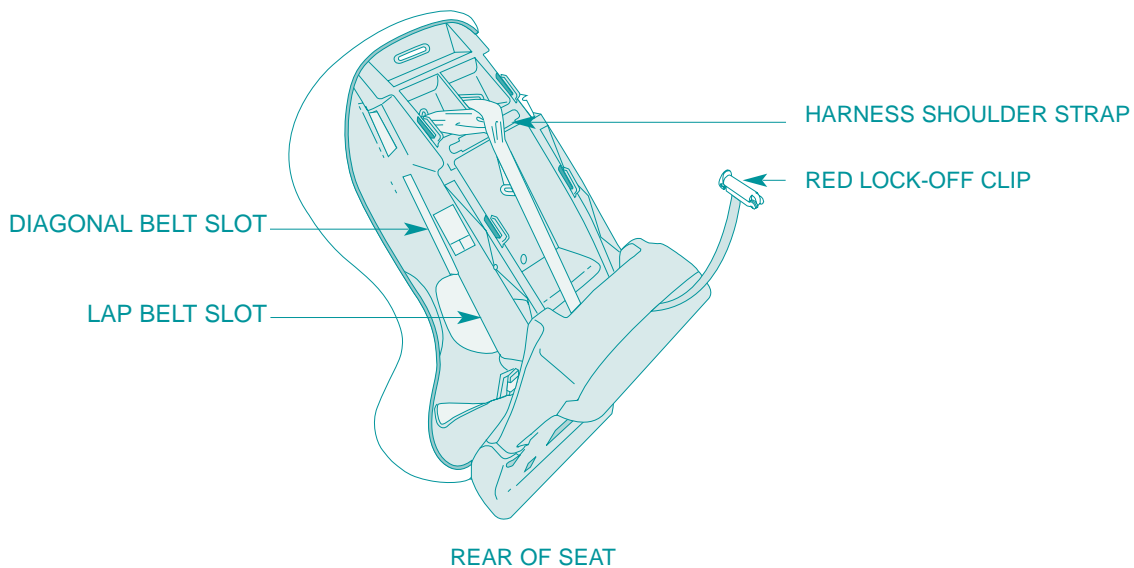
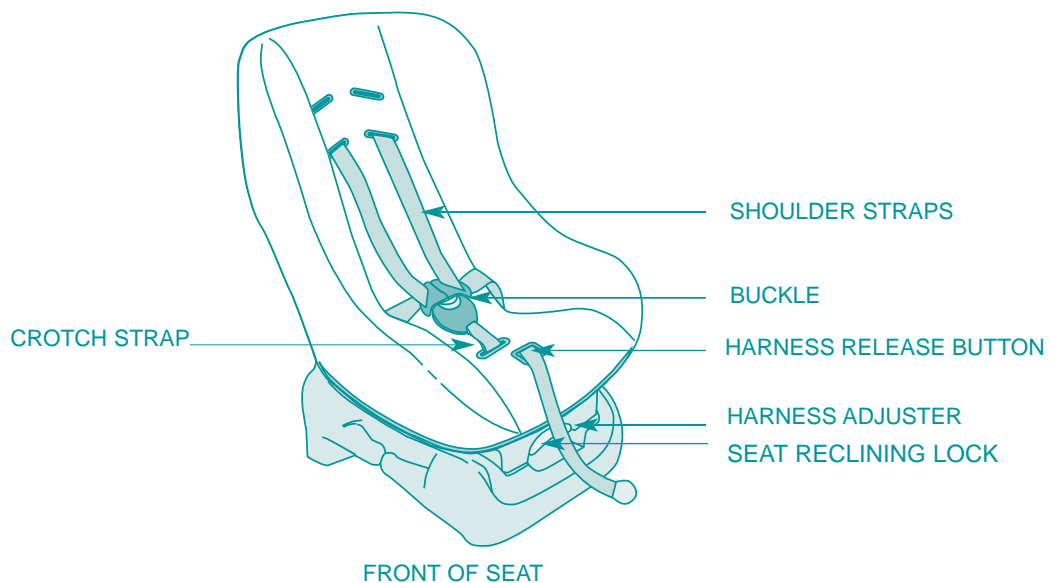

3

The type of approved seat belt you must have

DO NOT USE THIS CHILD SEAT IN PASSENGER SEATS EQUIPPED WITH AIRBAGS
Your Mothercare child seat can only be installed with this seat belt configuration.

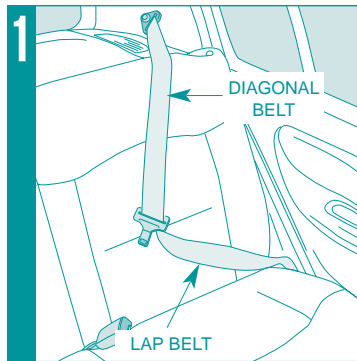

A lap and diagonal seat belt in the front or rear passenger seats of a car.

4

Legal requirements

This child seat is approved to ECE R44.03 and is suitable for use with only a 3 point lap and diagonal seat belt. This type must be approved to UN/ECE Regulation No.16 or other equivalent safety standards.

Front Seat

Anyone, especially children, travelling in the front seat of a car must be properly restrained. Children under three years must use a suitable approved restraint designed for their weight.

Rear Seat

All adults and children must use seat belts or child restraints where they are fitted in the rear of a car and are available for use.

If the appropriate restraint is not available, children from 3 years **must** wear an adult seat belt if available.

5

Important notes

- Keep this user guide in a safe place where it can easily be found.
- When the child seat is not in use, it is recommended that it is fastened into the car with a seat belt to avoid being thrown about in the event of an accident.
- In an emergency your child can be released quickly by pressing the red button on the harness buckle.
- If you travel with passengers using both the front and rear seats, the lighter occupants should be in the rear seats and the heavier occupants in the front of the vehicle. When a child is in the front seat, the lighter passenger should be behind the child.
- Do not allow the child seat to come into contact with corrosive substances e.g. battery acid.

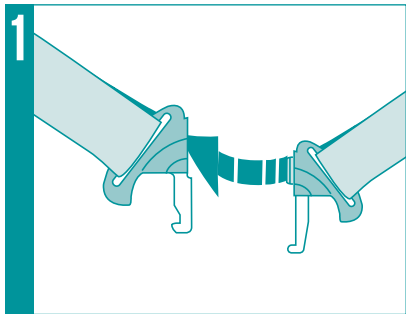
Doing up the harness

Place the left hand harness connector behind the right hand one, they should slot together neatly.

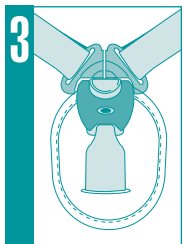
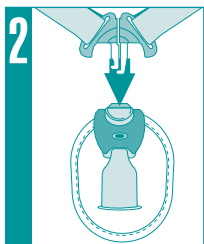

Push the harness ends into the hole in the buckle at the top of the crotch strap.

You will hear and feel a 'CLICK' when it is secure.

Check by attempting to remove the connectors by pulling the webbing above and below the buckle. Periodically check that your child has not released the buckle

(To release the harness, press the red button down.)

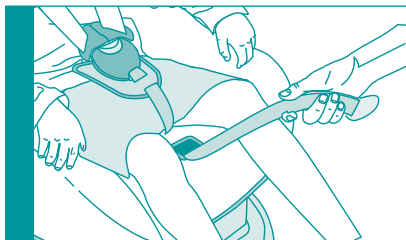
Tightening the harness

Pull gently on the harness adjuster to take up any slack in the harness.

A loose harness is dangerous, check it every time you use the seat.

It is recommended that there is just enough room to insert one finger between the shoulder straps and the child's' chest.

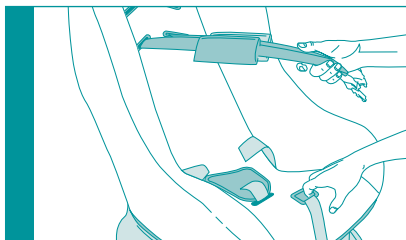
Loosening the harness

If the harness is too tight, loosen it by pulling on both straps.

At the same time, press on the tab through the hole in the seat cover.

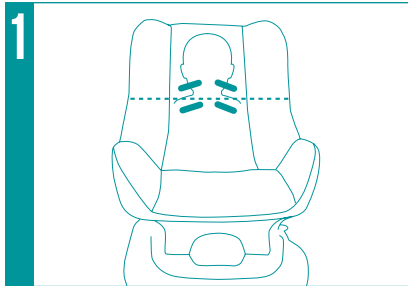
Adjusting the shoulder height

The harness has 2 height positions.

The straps should go into the slots at, or the nearest slot above the height of your child's' shoulders.

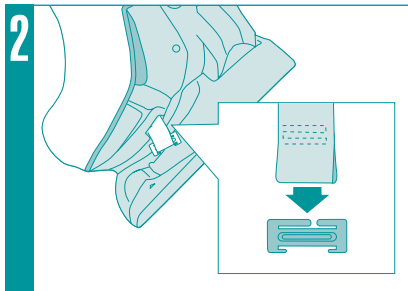

To adjust the shoulder straps of the harness, turn the seat upside down and remove the blue plastic clip from the end of ONE of the straps. Leave the other shoulder strap in place as a reference for now.

Feed the strap through the **BOTTOM** of the child seat.

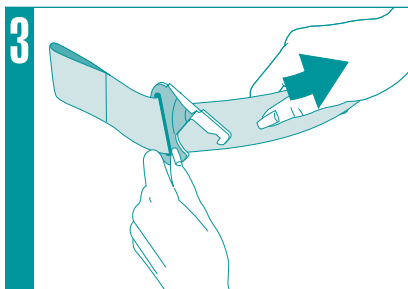

Remove the buckle connector from the strap.

Feed the strap through the **BACK** of the car seat and then return it through the slot at the correct height.

Replace the buckle connector, then push the shoulder strap back through the **BOTTOM** of the child seat. Re-fit the blue plastic clip.

Repeat the process for the other shoulder strap.

Fitting your child seat into your car

WARNING: Do not use this child seat in passenger seats fitted with airbags.
Do not use on rear-facing or side-facing vehicle seats.
If the seat recline angle is changed after installation, the seat belt must be re-tightened and the red 'lock-off' must be adjusted.

From 9kg to 18kg - forward facing - using a 3 point seat belt

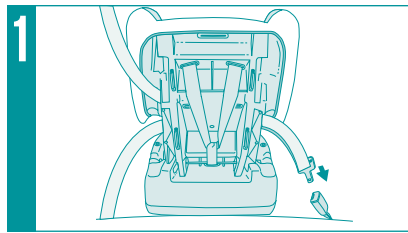

Place the child's car seat on the passenger seat with a 3 point seat belt. Make sure it is facing towards the front of the car. Pull the lap and diagonal sections of the car seat belt out until fully extended and pass the buckle through the belt slots in the sides of the child seat. Open the flap on the front of the seat cover to make it easier to pull the buckle through. The lap belt should pass across the bottom of the slot, and the diagonal belt through the top of the slot. Fasten the seatbelt in the normal way.

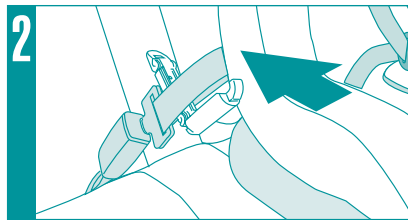

Open the red 'lock off' clip, on the vehicle seat belt buckle side of your child seat, feed just the shoulder (diagonal) section of the car seat belt through the 'lock off' clip as shown in the picture opposite.

Fasten the seat belt in the normal way.

Make sure that there are no kinks or twists in the car seat belt.

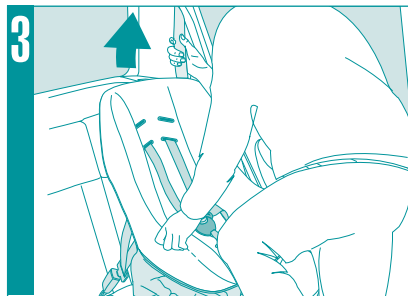

Put your knee on the child seat to push it right down into the car seat. Pull the diagonal section of the seat belt in the direction shown to tighten it.

At the same time close the red 'lock off' clip and 'lock it off' by pushing down the lock until it clicks. Ensure that the 'lock off' clip is tightly against the car seat buckle.

Your car seat should now be fixed securely with no slack. Make sure it is. To release the child seat when you want to remove it, first undo the 'lock off' clip, then the car seat belt.

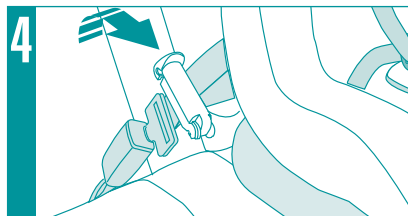

IMPORTANT

If you change the seat angle you should re-tighten the seat belt and re-fit the red 'lock off' clip to ensure the seat belt is tight.

8

Reclining your child seat

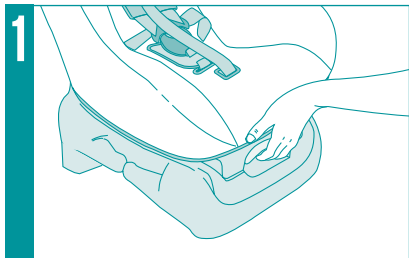

Your baby seat can be reclined in a choice of five positions to make it comfortable for your child.

To do this, pull the lever under the seat up and forward. This releases the lock, enabling the seat shell to recline or move back to the upright position.

Release the lever to lock the child seat in the chosen position.

CAUTION

Before changing the recline position of the child seat, you must release the seat belt.

Then re-fit the seat belt, re-tighten it, and adjust the red 'lock-off clip'.

See the section entitled 'Fitting the child seat into your car'.

9

Final checklist

However safe a child seat is, however well built it is, your child's' safety depends on you.

Read this final checklist once you have fitted your child seat in your car.

1. Check that you have adjusted the harness to suit your child. A fitting for winter clothes will be too loose for a child wearing summer clothes.
2. Check you have installed your child seat properly using a 3 point lap and diagonal belt - see section 7, fitting your child seat into your car.
3. Check that your child seat is secure before each journey.
4. Make sure that there are no kinks or twists in the car seat belt.

REMEMBER: Misusing your child seat will reduce the protection and safety you offer your child.

10

Accessories

Your child seat and its cover have been carefully designed, manufactured and tested to the highest safety standards.

Do not put your child's' safety at risk by using without a seat cover. The seat cover should not be replaced with any other than the one recommended by Mothercare, because the cover constitutes an integral part of the restraint performance.

The safety of this seat may be compromised by the use of accessories not approved by Mothercare.

Removing the fabric cover

The fabric cover can be removed from the seat. You will have to remove the harness and crotch strap first.

To remove the harness, remove the plastic retaining clips as shown in section 6, picture 2, before pulling the harness through the seat base.

Remove the crotch strap by placing the seat in the fully reclined position as described in section 8. Find the securing plate located underneath the seat and then twist and push the securing plate through the hole on the bottom of the car seat. Release the elasticated edges of the cover from the seat. Carefully remove the cover.

The cover can be machine washed by following the instructions on the care label which is sewn into the cover.

Cleaning the seat

The harness and plastic parts can be sponged with a mild detergent and warm water.

Ensure no soap gets into the buckle or adjusters.

Do not use chemical cleaners or bleach on any part of the car seat.

Dry thoroughly before use.

Your child's safety is your responsibility

If you have a problem with this product or require replacement parts, please contact your nearest Mothercare store or telephone the Mothercare Customer Care Line on 01923 210 210.

Alternatively, write to:

Mothercare, Customer Care, Cherry Tree Road, Watford, Herts, WD24 6SH

The replacement parts listed below are available for your product. In the event that you require any of these parts, please contact your local Mothercare store or contact Customer Care on 01923 210210.

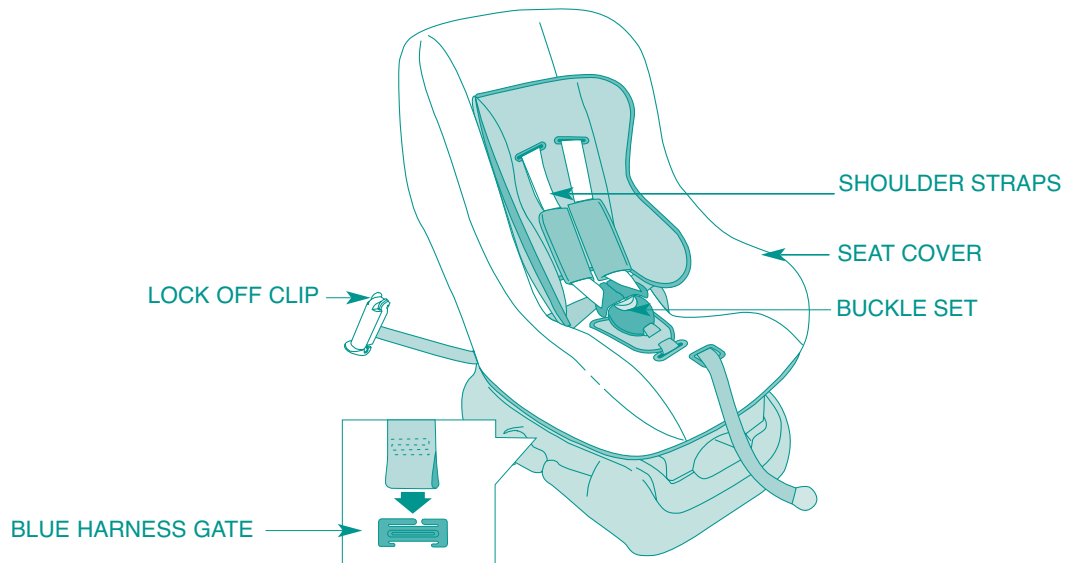

Replacement Part

Seat Cover (Silver Pancake)
Shoulder Straps
Lock off
Buckle Set

SKU Number

5636141
5636158
5636165
5636172

Notice

1. This is a 'Universal' child restraint. It is approved to ECE Regulation No. 44.03 series of amendments, for general use in vehicles and it will fit most, but not all car seats.
2. A correct fit is likely if the vehicle manufacturer has declared that the vehicle is capable of accepting a 'Universal' child restraint for this age group.
3. This child restraint has been classified as 'Universal' under more stringent conditions than those which applied to earlier designs which do not carry this notice.
4. If in doubt, consult either the child restraint manufacturer or the retailer.
5. Only suitable if the approved vehicles are fitted with 3 point static or retractor safety belts approved to UN/ECE Regulation No. 16 or other equivalent standards.