

mothercare

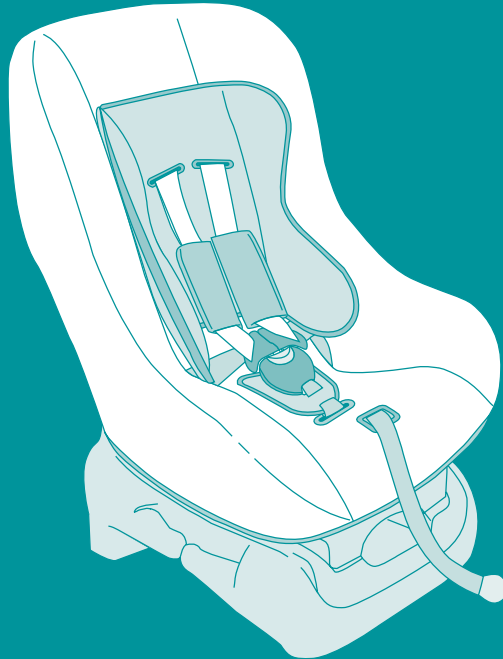

## Challenger & Oregon Car Seats

### User Guide

IMPORTANT

Please retain this User Guide for future reference

Conforms to  
ECE R44.03  
Universal

***EXTREME HAZARD: Parents should not under any circumstances use this child restraint on a passenger seat equipped with an airbag.***

- PLEASE READ THOROUGHLY BEFORE COMMENCING INSTALLATION AS AN INCORRECT INSTALLATION COULD BE DANGEROUS.
- DO NOT USE THIS CHILD SEAT IN PASSENGER SEATS EQUIPPED WITH AIRBAGS.
- This child seat can be installed in either a forward or rearward facing position. Do not use on side facing or rear facing seats.
- Never use this child seat without fastening the child's harness correctly, and never attempt to use it without fastening it into the car as described in these instructions.
- When using the child seat, it is most important that the car seat belt is correctly routed. Ensure the belt straps are not kinked.
- The child seat must be tightened down on the upholstery as tight as possible to ensure maximum protection. The recommended method is shown in these instructions.
- Do not add to or modify the seat in any way.
- It is recommended that this car seat should be changed when it has been subjected to violent stresses in an accident or has become badly worn. Periodically inspect the harness for wear, paying particular attention to the attachment points, stitching and adjusting devices.
- Do not leave your child unattended in the seat at any time.
- Ensure that no part of the seat is trapped in a door or folding seat. If your car has a folding rear seat, ensure that it is correctly latched in the upright position.
- Car interiors can become very hot when in direct sunlight, it is therefore recommended that the child seat is covered when not in use. This prevents components, particularly those attached to the child seat, becoming hot and burning the child.
- In the event of an emergency it is important that the child can be released quickly. This means that the buckle is not fully tamper-proof, so your child must be taught never to play with the buckle.
- Luggage and other heavy or sharp objects should be secured in the car. Loose objects are liable to cause injury in the event of an accident.
- The safest seating position for a child's car seat is on the rear seat of a vehicle.

## Getting to know your child seat

This seat is classified as Group 0+ for children from birth to 13kg (birth to 12-15 months approx.) - in a rearward facing position.

This seat is also classified as Group 1 for children weighing 9kg to 18kg (9 months - 4 years approx.) - in a forward facing position. Do not use forward facing before your child's weight exceeds 9 kg

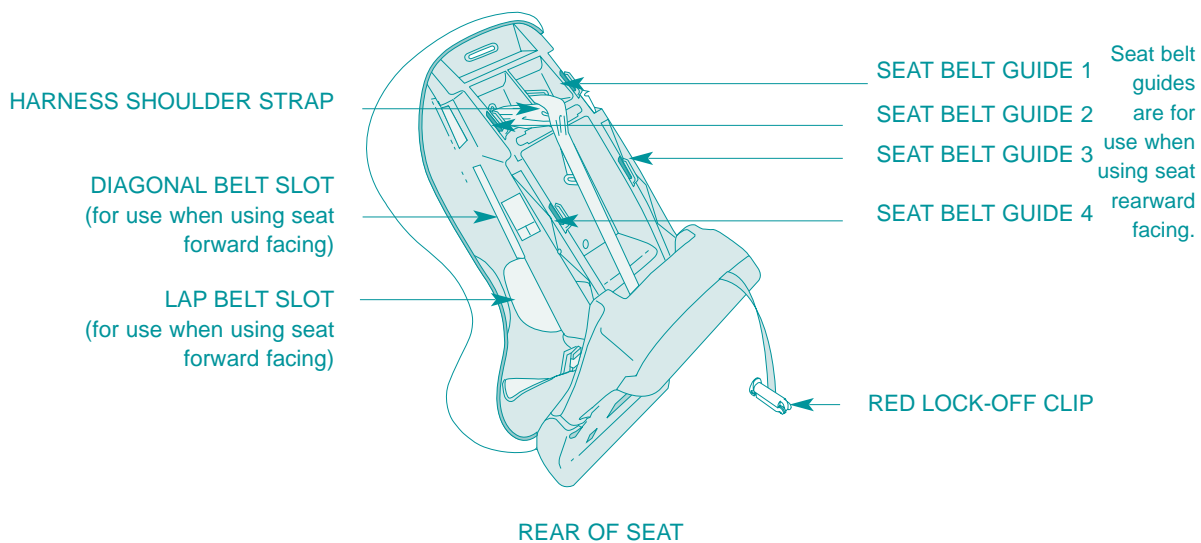
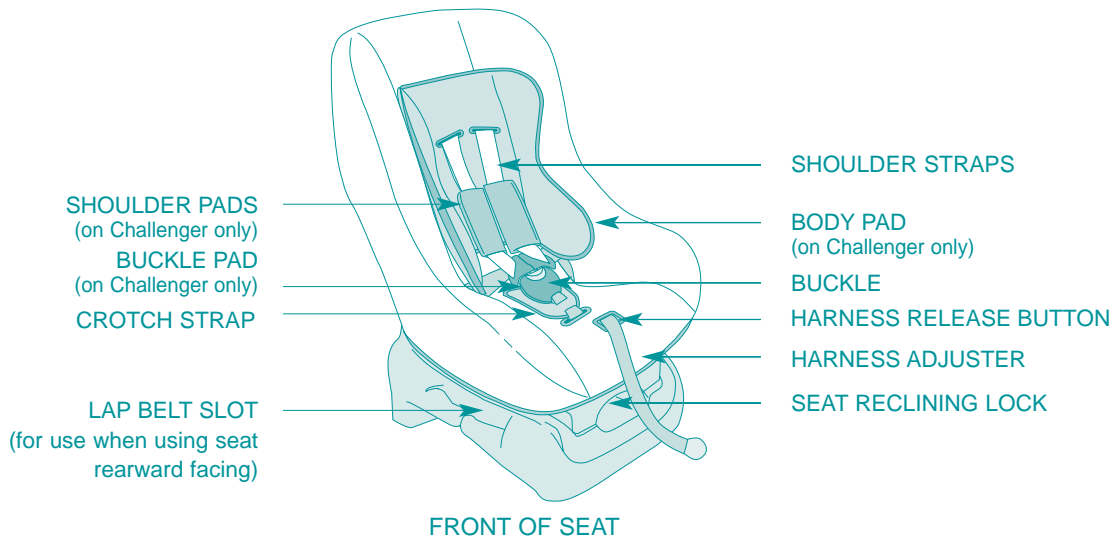

**3**

## The type of approved seat belt you must have

### DO NOT USE THIS CHILD SEAT IN PASSENGER SEATS EQUIPPED WITH AIRBAGS

Your Mothercare child seat can only be installed with this seat belt configuration.

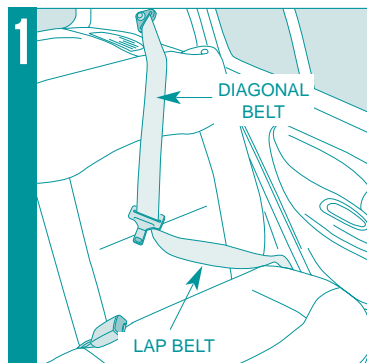

A lap and diagonal seat belt in the front or rear passenger seats of a car.

**4**

## Legal requirements

This child seat is approved to ECE R44.03 and is suitable for use with only a 3 point lap and diagonal seat belt (in a forward or rearward facing position).

This type must be approved to UN/ECE Regulation No.16 or other equivalent safety standards.

### Front Seat

Anyone, especially children, travelling in the front seat of a car must be properly restrained. Children under three years must use a suitable approved restraint designed for their weight.

### Rear Seat

All adults and children must use seat belts or child restraints where they are fitted in the rear of a car and are available for use.

If the appropriate restraint is not available, children from 3 years **must** wear an adult seat belt if available.

**5**

## Important notes

- Keep this user guide in a safe place where it can easily be found.
- When the child seat is not in use, it is recommended that it is fastened into the car with a seat belt to avoid being thrown about in the event of an accident.
- In an emergency your child can be released quickly by pressing the red button on the harness buckle.
- If you travel with passengers using both the front and rear seats, the lighter occupants should be in the rear seats and the heavier occupants in the front of the vehicle. When a child is in the front seat, the lighter passenger should be behind the child.
- Do not allow the child seat to come into contact with corrosive substances e.g. battery acid.

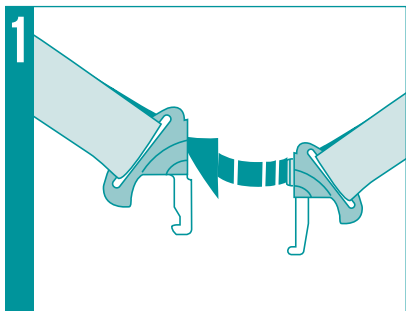
*Doing up the harness*

Place the left hand harness connector behind the right hand one, they should slot together neatly.

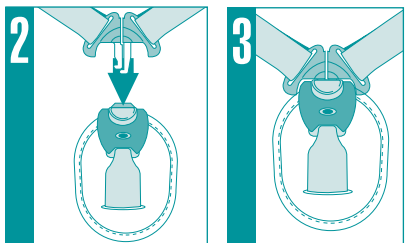

Push the harness ends into the hole in the buckle at the top of the crotch strap. You will hear and feel a 'CLICK' when it is secure.

Check by attempting to remove the connectors by pulling the webbing above and below the buckle. Periodically check that your child has not released the buckle.

(To release the harness, press the red button down.)

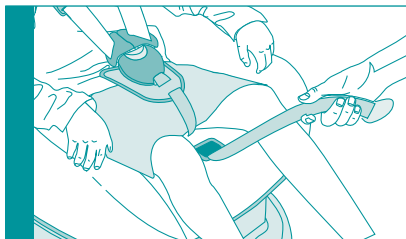
*Tightening the harness*

Pull gently on the harness adjuster to take up any slack in the harness.

A loose harness is dangerous, check it every time you use the seat.

It is recommended that there is just enough room to insert one finger between the shoulder straps and the child's chest.

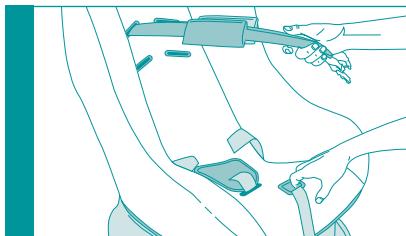
*Loosening the harness*

If the harness is too tight, loosen it by pulling on both straps.

At the same time, press on the tab through the hole in the seat cover.

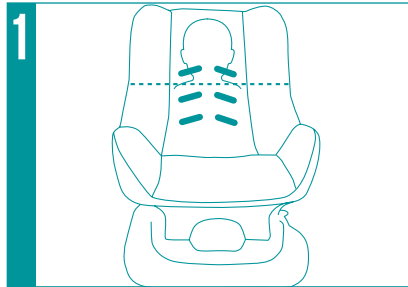
**Adjusting the shoulder height**

The harness has 3 height positions.

**WHEN USING THE SEAT REARWARD FACING**

The straps should go into the lower or middle slots closest to your child's shoulders.

**WHEN USING THE SEAT FORWARD FACING**

The straps should go into the middle or upper slots at, or just above the height of your child's shoulders.

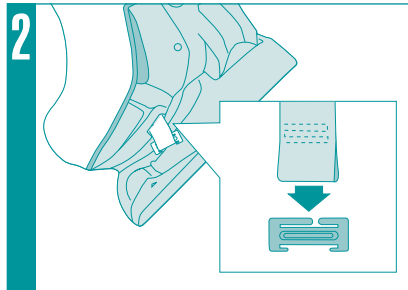

To adjust the shoulder straps of the harness, turn the seat upside down and remove the blue plastic clip from the end of ONE of the straps. Leave the other shoulder strap in place as a reference for now.

Feed the strap through the **BOTTOM** of the child seat.

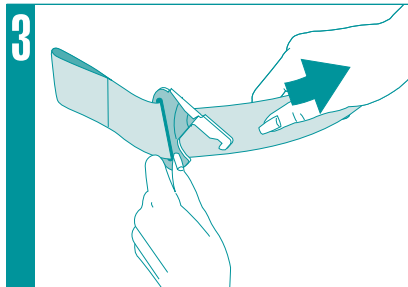

Remove the buckle connector from the strap.

Feed the strap through the **BACK** of the car seat and then return it through the slot at the correct height.

Replace the buckle connector, then push the shoulder strap back through the **BOTTOM** of the child seat. Re-fit the blue plastic clip.

Repeat the process for the other shoulder strap.

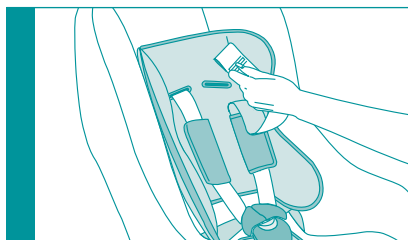
**Fitting the body pad (on Challenger only)**

Refer to 2 and 3 above for guidelines on adjusting each shoulder strap. Only remove one strap at a time, leave the other shoulder strap in place as a reference. Position the body pad at a height which gives your child maximum support. When replacing the shoulder straps thread them through the body pad to hold it in place.

## Fitting your child seat into your car

**WARNING:** Do not use this child seat in passenger seats fitted with airbags.  
Do not use on rear-facing or side-facing vehicle seats.  
If the seat recline angle is changed after installation, the seat belt must be re-tightened and the red 'lock-off' (when fitted) must be adjusted.

### From birth to 13kg - rearward facing - use 3 point seat belts only

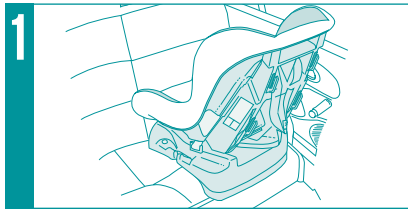

1 Make sure the child seat is in its fully reclined position (see page 11). Place the child's car seat on a passenger seat in the front or rear of a car with a 3 point seat belt. Make sure the child seat is facing towards the rear of the car.

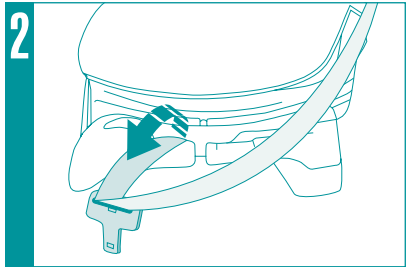

2 Pull the lap and diagonal sections of the car seat until they are fully extended and then pull the lap section underneath the bottom of the child seat.

Fasten the seat belt in the normal way.

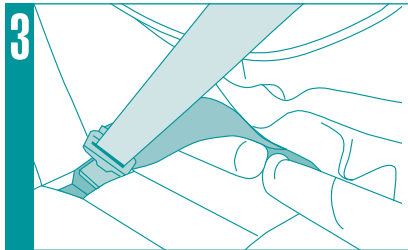

3 Make sure that the lap section of the seat belt runs through the slots provided on both sides of the child seat base.

Make sure that there are no kinks or twists in the car seat belt.

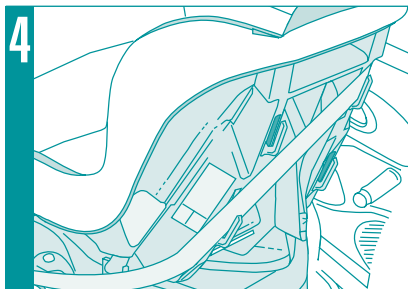

4 Thread the diagonal strap through the slots located on the back of the seat. Guides 1 & 4 should be used with the car seat on the left hand side of the car and guides 2 & 3 with the car seat on the right hand side of the car.

## Fitting your child seat into your car

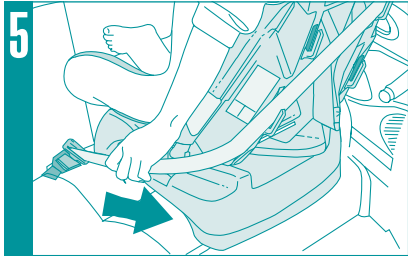

Tighten the diagonal section of the seat belt by pulling it in the direction shown. Your car seat should now be fixed securely. Make sure it is.

Check that there are no kinks or twists in the car seat belt.

### From 9kg to 18kg - forward facing - using a 3 point seat belt

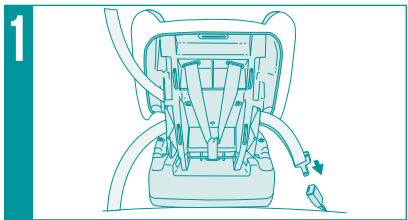

Place the child's car seat on the passenger seat with a 3 point seat belt. Make sure it is facing towards the front of the car. Pull the lap and diagonal sections of the car seat belt out until fully extended and pass the buckle through the belt slots in the sides of the child seat. Open the flap on the front of the seat cover to make it easier to pull the buckle through. The lap belt should pass across the bottom of the slot, and the diagonal belt through the top of the slot. Fasten the seatbelt in the normal way.

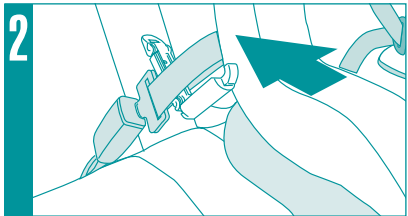

Then open the red 'lock off' clip and position it just above the buckle, lay only the diagonal section of the seat belt on it and leave it open.

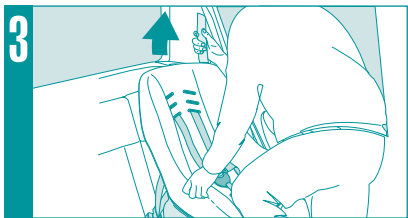

Put your knee on the child seat to push it right down into the car seat. Tighten the shoulder section of the seat belt by pulling it in the direction shown. Pull the diagonal belt up and it pull tight - use your other hand to partially close the 'lock off' clip.

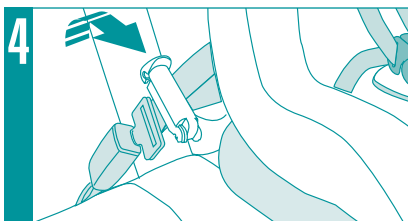

Close the 'lock off' clip and secure its catch. Ensure that the 'lock off' clip is tightly against the car seat buckle.

Your car seat should now be fixed securely. Make sure it is.

#### IMPORTANT

If you change the seat angle you should re-tighten the seat belt and re-fit the red 'lock off' clip to ensure the seat belt is tight.

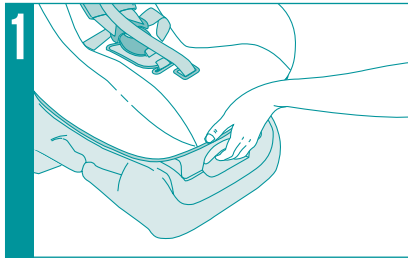

In a forward facing position your baby seat can be reclined in a choice of five positions to make it comfortable for your child.

To do this, lift and then pull the lever under the seat forward. This releases the lock, enabling the seat shell to recline or move back to the upright position.

Release the lever to lock the child seat in the chosen position.

**IMPORTANT:** In the rearward facing position you must only use the most reclined position.

### CAUTION

Before changing the recline position of the child seat, you must release the seat belt.

Then re-fit the seat belt, re-tighten it, and adjust the red 'lock-off clip'. See the section entitled 'Fitting the child seat into your car'.

## Final checklist

However safe a child seat is, however well built it is, your child's safety depends on you. Read this final checklist once you have fitted your child seat in your car.

1. Check that you have adjusted the harness to suit your child. A fitting for winter clothes will be too loose for a child wearing summer clothes.
2. Check you have installed your child seat properly using a 3 point lap - see section 7, fitting your child seat into your car.
3. Check that your child seat is secure before each journey.
4. Make sure that there are no kinks or twists in the car seat belt.

REMEMBER: Misusing your child seat will reduce the protection and safety you offer your child.

## Accessories

Your child seat and its cover have been carefully designed, manufactured and tested to the highest safety standards.

Do not put your child's safety at risk by using without a seat cover. The seat cover should not be replaced with any other than the one recommended by Mothercare, because the cover constitutes an integral part of the restraint performance.

The safety of this seat may be compromised by the use of accessories not approved by Mothercare.

## Care of your product

### *Removing the fabric cover*

---

The fabric cover can be removed from the seat. You will have to remove the harness and crotch strap first. To remove the harness, remove the plastic retaining clip clips as shown in section 6, picture 2, and then pull the harness through the seat base. Remove the crotch strap by placing the seat in the fully reclined position as described in section 8. Find the securing plate located underneath the seat and then twist and push the securing plate through the hole on the bottom of the car seat. Release the elasticated edges of the cover from the seat. Carefully remove the cover. The cover can be machine washed by following the instructions on the care label which is sewn into the cover.

### *Cleaning the seat*

---

The harness and plastic parts can be sponged with a mild detergent and warm water. Ensure no soap gets into the buckle or adjusters. Do not use chemical cleaners or bleach on any part of the car seat. Dry thoroughly before use.

## 12

## Replacement Parts

The replacement parts listed below are available for your product. In the event that you require any of these parts, please contact your local Mothercare store or contact Customer Care on 01923 210210.

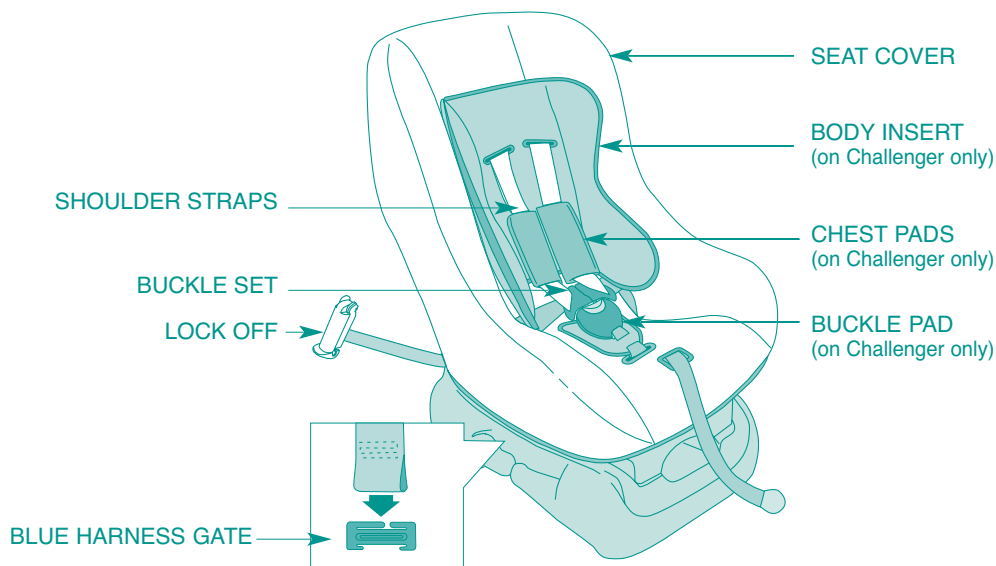

### Replacement Part

Seat Cover  
Chest Pads  
Buckle Pad  
Shoulder Straps  
Body Insert  
Lock off  
Buckle Set  
Blue harness Gate

### Challenger SKU Number

5636288 (Brighton check)  
5636295  
5636301  
5636318  
5636325  
5636332  
5636349  
5636363

### Oregon SKU Number

5636226 (Sheep)  
N/A  
N/A  
5636233  
N/A  
5636240  
5636257  
5636271

## 13

## Customer Care

Your child's safety is your responsibility

If you have a problem with this product or require replacement parts, please contact your nearest Mothercare store or telephone the Mothercare Customer Care Line on 01923 210 210.

Alternatively, write to:

Mothercare  
Customer Care  
Cherry Tree Road  
Watford  
Herts  
WD24 6SH

## Notice

1. This is a 'Universal' child restraint. It is approved to ECE Regulation No. 44.03 series of amendments, for general use in vehicles and it will fit most, but not all car seats.
2. A correct fit is likely if the vehicle manufacturer has declared that the vehicle is capable of accepting a 'Universal' child restraint for this age group.
3. This child restraint has been classified as 'Universal' under more stringent conditions than those which applied to earlier designs which do not carry this notice.
4. If in doubt, consult either the child restraint manufacturer or the retailer.
5. Only suitable if the approved vehicles are fitted with 3 point static or retractor safety belts approved to UN/ECE Regulation No. 16 or other equivalent standards.