

your child's safety is your responsibility

If you have a problem with this product or require any replacement parts, please contact your nearest Mothercare store or telephone the Mothercare Customer Care Line on 08453 30 40 30



alternatively write to:

Customer care
Mothercare
Cherry Tree Road
Watford
Herts. WD24 6SH

www.mothercare.com

la seguridad de su niño es su responsabilidad

Si surgiera algun problema con este producto o si necesita piezas de recambio sirvase ponerse en contacto con el almacen Mothercare mas proximo o llamar a la linea de Atencion al cliente de Mothercare numero (+44) 1923 210 210

tambien puede escribir a:

Customer care
Mothercare
Cherry Tree Road
Watford
Herts. WD24 6SH
England

www.mothercare.com

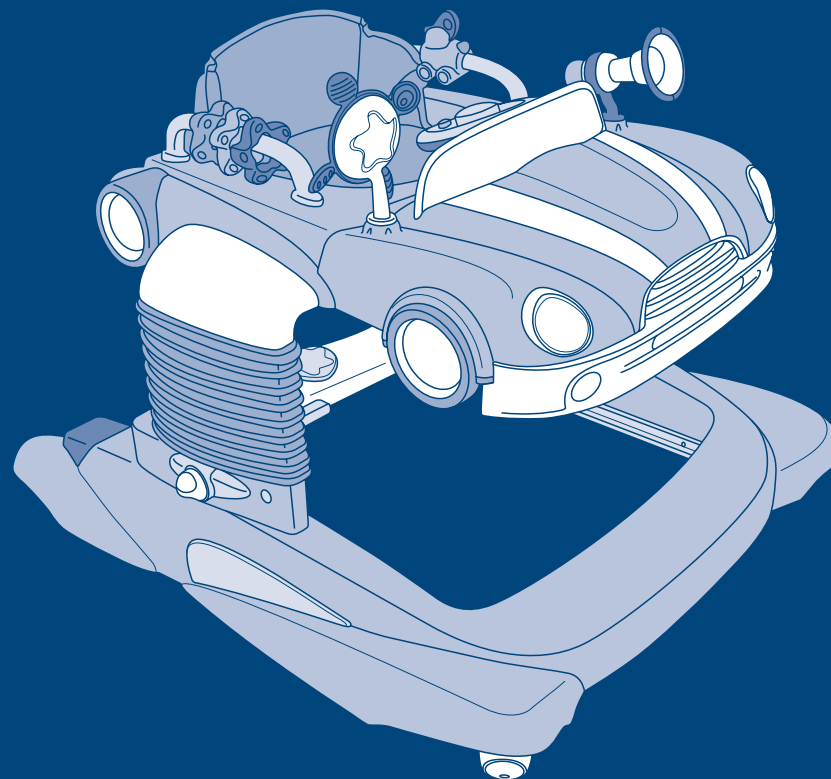

Car Walker

user guide

Important. Keep for
future reference

Car Walker

guia para usuario

Importante. Retenga para
referencia futura

Made in China

1

introduction • introducción

The Mothercare 3-in-1 Convertible Car Walker can be used as a jumper, walker and push along entertainment unit for children who are eager to walk. Only use the Car Walker in walker or jumper mode when your child can sit unaided, from approximately 6 months of age. These modes are not intended for children who can walk by themselves, weigh more than 12kgs or are taller than 85cm. Only use the Car Walker in push along mode when your child can walk unaided, from approximately 9+ months. The Car Walker conforms to BS EN 1273:2005.

The Mothercare 3-in-1 Convertible Car Walker can be used as a jumper, walker and push along entertainment unit for children who are eager to walk. Only use the Car Walker in walker or jumper mode when your child can sit unaided, from approximately 6 months of age. These modes are not intended for children who can walk by themselves, weigh more than 12kgs or are taller than 85cm. Only use the Car Walker in push along mode when your child can walk unaided, from approximately 9+ months. The Car Walker conforms to BS EN 1273:2005.

2

parts check list • catálogo de piezas

Seat and upper plate

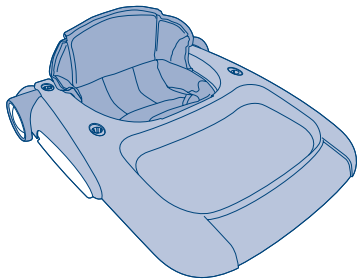

Seat and upper plate

Lower base and kick pad

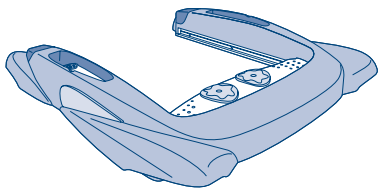

Lower base and kick pad

Support legs (2)

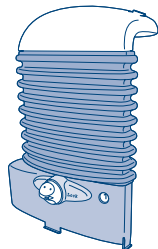

Support legs (2)

2

parts check list • catálogo de piezas

Toy tray

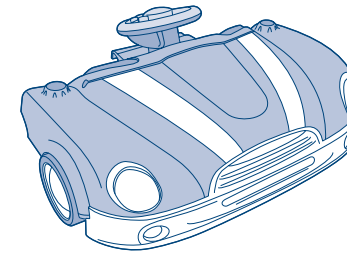

Toy tray

Handrails

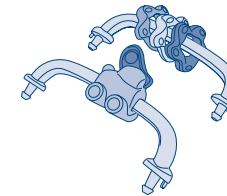

Handrails

Wheels (4)



Wheels (4)

Windscreen

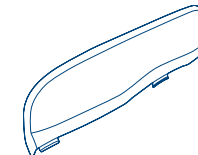

Windscreen

Fan and horn toys

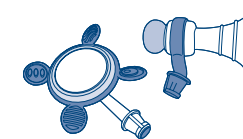

Fan and horn toys

Number plate stickers

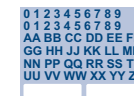

Number plate stickers

3 preparation for use • preparación para el uso

assembling the car walker

assembling the car walker

1

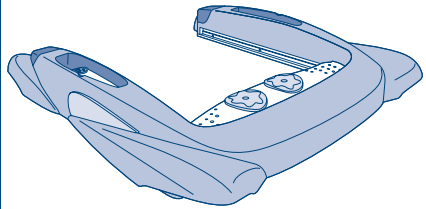

Press the button in the centre of the kick pad and slide it along the runners to the back of the base to form a square.

Press the button in the centre of the kick pad and slide it along the runners to the back of the base to form a square.

2

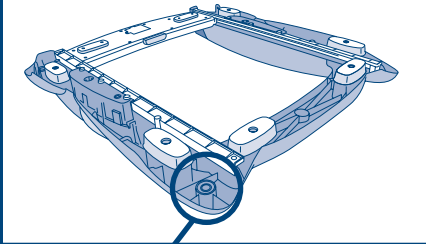

Turn the base over and insert the wheels. There are four and they slot into the holes in each of the four corners of the base. Make sure you push each wheel all the way in.

Turn the base over and insert the wheels. There are four and they slot into the holes in each of the four corners of the base. Make sure you push each wheel all the way in.

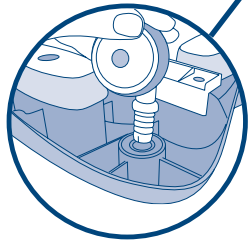

3

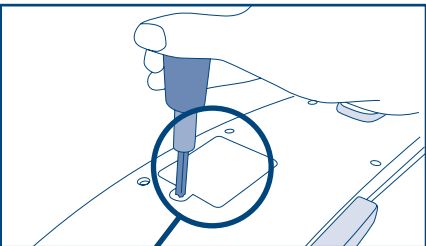

Unscrew the battery cover using a Phillips screwdriver and insert 3 AA batteries into the battery compartment on the kick pad.

Unscrew the battery cover using a Phillips screwdriver and insert 3 AA batteries into the battery compartment on the kick pad.

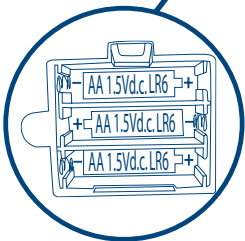

3 preparation for use • preparación para el uso

preparation for use • preparación para el uso

4

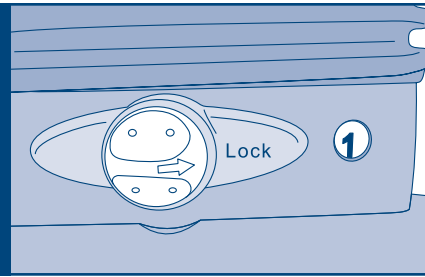

Make sure the dial on each support leg is set to Lock.
NOTE: The number 1 indicates the height setting of the walker. For more information, please see the 'Adjusting the height of the car walker' section in this guide.

Make sure the dial on each support leg is set to Lock.
NOTE: The number 1 indicates the height setting of the walker. For more information, please see the 'Adjusting the height of the car walker' section in this guide.

5

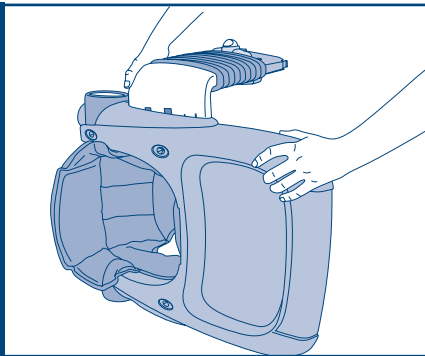

Rest the seat unit on its side and push each support leg into the slots on either side until they click into place. Make sure they are secure by tugging on each leg.

Rest the seat unit on its side and push each support leg into the slots on either side until they click into place. Make sure they are secure by tugging on each leg.

6

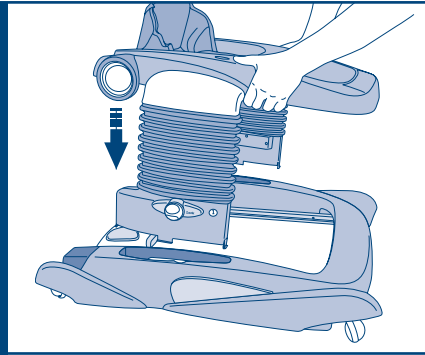

Lower the assembled seat unit and support legs onto the base. Slot the legs into the holes on either side of the base and push down until they click into place. Make sure the structure is secure by lifting it by the seat unit to check the base doesn't fall away.

Lower the assembled seat unit and support legs onto the base. Slot the legs into the holes on either side of the base and push down until they click into place. Make sure the structure is secure by lifting it by the seat unit to check the base doesn't fall away.

3 preparation for use • preparación para el uso

attaching the toys

attaching the toys

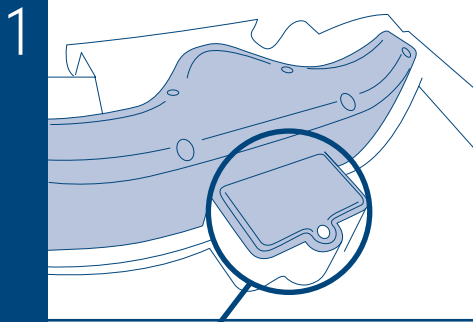

Before attaching the car toy tray to the seat unit, turn the toy tray over and insert two AA batteries into the battery compartment on the underside. You'll need a small Phillips screwdriver to open the battery cover.

Before attaching the car toy tray to the seat unit, turn the toy tray over and insert two AA batteries into the battery compartment on the underside. You'll need a small Phillips screwdriver to open the battery cover.

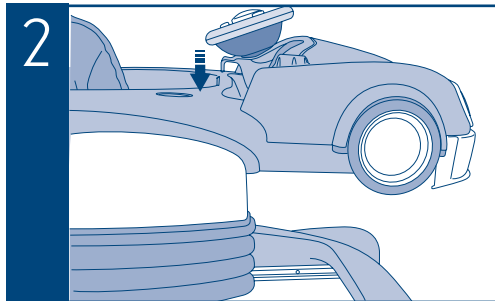
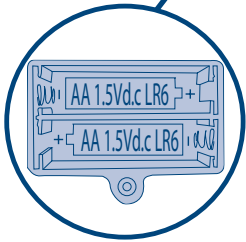

Clip the car toy tray on to the front of the seat unit. It will click into place. To replace the batteries in the toy tray, unclip the tray by pushing the buttons located underneath it on the inside of each front wheel, then lift the toy tray away.

Clip the car toy tray on to the front of the seat unit. It will click into place. To replace the batteries in the toy tray, unclip the tray by pushing the buttons located underneath it on the inside of each front wheel, then lift the toy tray away.

3 preparation for use • preparación para el uso

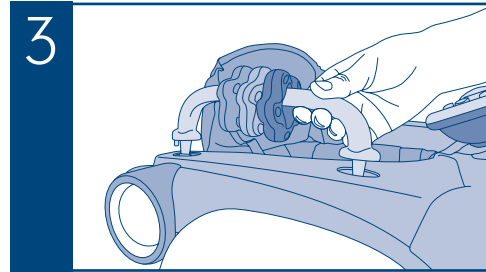

Attach the handrails by slotting the ends into the holes on either side of the seat.

Attach the handrails by slotting the ends into the holes on either side of the seat.

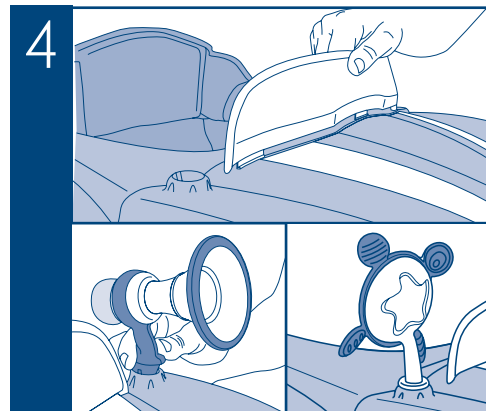

Clip the windscreen, horn and mirror into the holes on the car toy tray as shown.

Clip the windscreen, horn and mirror into the holes on the car toy tray as shown.

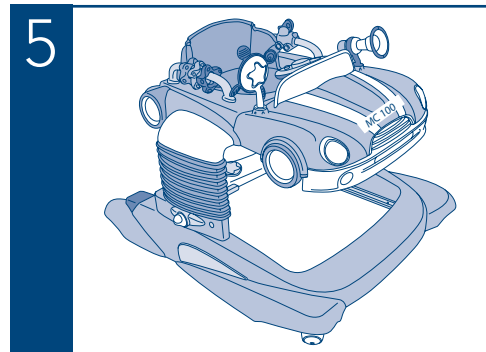

Use the alphabet stickers to create the number plate of your choice. First apply the white number plate sticker to the toy tray, then add your chosen letters and numbers to the plate sticker.

WARNING! Adult supervision required.

Use the alphabet stickers to create the number plate of your choice. First apply the white number plate sticker to the toy tray, then add your chosen letters and numbers to the plate sticker.

WARNING! Adult supervision required.

There are three different ways to use the Car Walker. The walker mode simply allows your child to use the Car Walker as an interactive support. The jumper mode allows your child to bounce up and down rather than walk. Once your child can walk unaided, the push along mode offers your child a fun walking support.

There are three different ways to use the Car Walker. The walker mode simply allows your child to use the Car Walker as an interactive support. The jumper mode allows your child to bounce up and down rather than walk. Once your child can walk unaided, the push along mode offers your child a fun walking support.

using your car walker in walker mode

using your car walker in walker mode

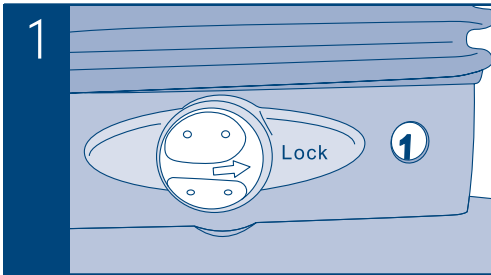

Ensure the dial on each leg support is set to lock.

Ensure the dial on each leg support is set to lock.

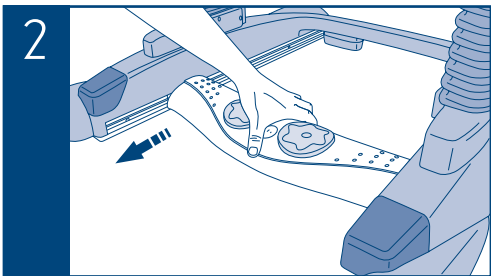

Press the button on the kick pad and slide it to the back of the base until it clicks into place.

Press the button on the kick pad and slide it to the back of the base until it clicks into place.

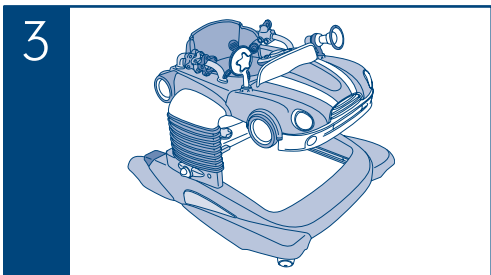

Ensure the backrest of the seat is vertically up and positioned over the 2x raised locations. Lower your child into the seat, so that his or her legs are through the two holes. Your child can now use the Car Walker as a fun and interactive support.

Ensure the backrest of the seat is vertically up and positioned over the 2x raised locations. Lower your child into the seat, so that his or her legs are through the two holes. Your child can now use the Car Walker as a fun and interactive support.

using your car walker in jumper mode

using your car walker in jumper mode

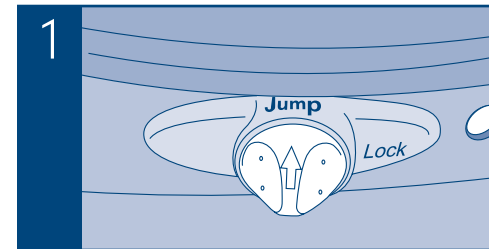

Set the dial on each leg support to Jump.

Set the dial on each leg support to Jump.

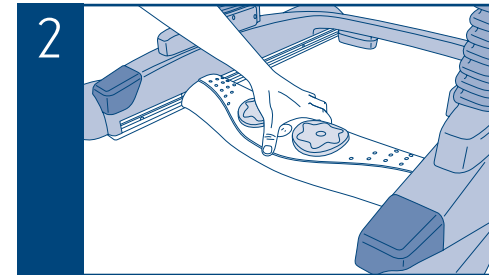

Press the button on the kick pad, slide it into the centre of the base and let it click into place.

Press the button on the kick pad, slide it into the centre of the base and let it click into place.

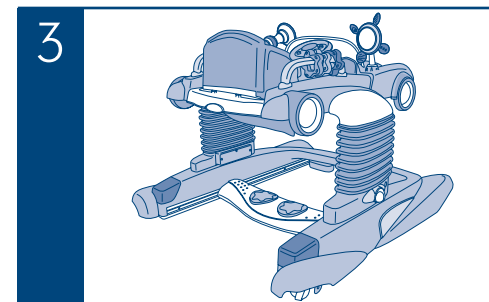

Lower your child into the seat, so that his or her legs fit through the two holes. Your child can now bounce away, hitting the kick pad buttons with his or her feet to make fun noises.

Lower your child into the seat, so that his or her legs fit through the two holes. Your child can now bounce away, hitting the kick pad buttons with his or her feet to make fun noises.

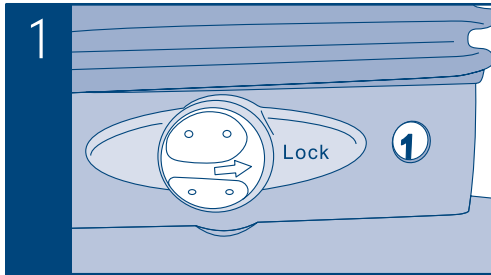
using your car walker in
push along modeusing your car walker in
push along mode

Set the dial on each leg support to Lock.

Set the dial on each leg support to Lock.

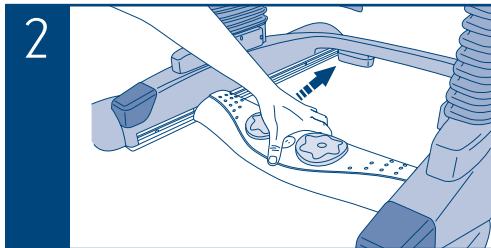

Press the button on the kick pad and slide it to the front of the base until it clicks into place.

Press the button on the kick pad and slide it to the front of the base until it clicks into place.

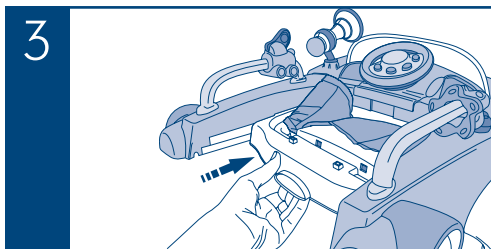

Fold the backrest forward into the seat and pulling the catch on the back of the seat, slide the seat unit into the toy tray as shown in the picture.

Fold the backrest forward into the seat and pulling the catch on the back of the seat, slide the seat unit into the toy tray as shown in the picture.

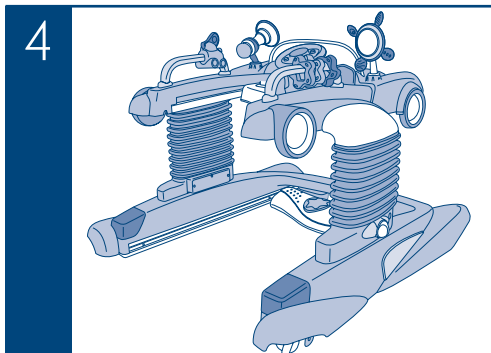

The Car Walker can now be used as a fun walking support in push along mode.

The Car Walker can now be used as a fun walking support in push along mode.

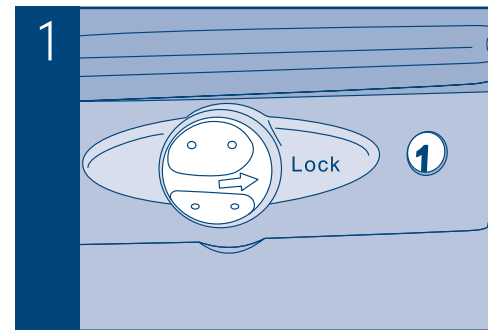
adjusting the height of the
car walkeradjusting the height of the
car walker

There are two height options for the Car Walker when used in walker or push along mode.

Remove your child from the seat, if in place. Switch both dials on the leg supports to Jump. Pull the seat unit up so that the number 1 appears in the small window next to the each dial, or push down until the number 2 appears. When the desired number is visible in both windows turn the dials on both sides to Lock.

There are two height options for the Car Walker when used in walker or push along mode.

Remove your child from the seat, if in place. Switch both dials on the leg supports to Jump. Pull the seat unit up so that the number 1 appears in the small window next to the each dial, or push down until the number 2 appears. When the desired number is visible in both windows turn the dials on both sides to Lock.

5

care of your product • cuidado del producto

The Car Walker can be cleaned by sponging with warm water and a mild detergent.
(Do not submerge the seat in water).
The Car Walker must be dried thoroughly before using or storing.
Never clean with abrasive, ammonia based, bleach based or spirit type cleaners.

The Car Walker can be cleaned by sponging with warm water and a mild detergent.
(Do not submerge the seat in water).
The Car Walker must be dried thoroughly before using or storing.
Never clean with abrasive, ammonia based, bleach based or spirit type cleaners.

6

safety notes • medidas de seguridad

As a parent or carer of children, we know that safety is of uppermost concern in your mind. Whilst this product has been developed to all of the relevant safety standards, we need your help to maintain that level of safety and minimise the risk that a baby using this product will be harmed. Your baby should never be left alone in the Walker and all tempting objects should be kept out of your child's reach.

As a parent or carer of children, we know that safety is of uppermost concern in your mind. Whilst this product has been developed to all of the relevant safety standards, we need your help to maintain that level of safety and minimise the risk that a baby using this product will be harmed. Your baby should never be left alone in the Walker and all tempting objects should be kept out of your child's reach.

WARNING! STAIR HAZARD. AVOID SERIOUS INJURY OR DEATH. BLOCK STAIRS/STEPS AND UNEVEN SURFACES BEFORE USING THE WALKER. USE A STAIR GATE AT ALL TIMES.

This walker is intended to be used by children who can sit unaided, approximately from 6 months. It is not intended for children weighing more than 12kg.

- The Car Walker should only be used under adult supervision. NEVER LEAVE YOUR CHILD UNATTENDED.
- Do not use the Car Walker until your child can sit up unaided.
- Use only for limited periods e.g. 20 minutes at a time, as it is not a training aid and excessive use might impair the child's walking development.
- Warning: your child will be able to reach further and move rapidly when in the baby walking frame.
- Prevent collisions with glass in doors, windows and furniture.
- Keep children away from the Walker during set-up and folding and when not in use.
- For indoors use only.
- Open fires, heaters and cooking appliances must be guarded by a nursery type fireguard.
- Remove hot liquids, electrical flexes and other potential hazards from your child's reach.
- Use only on flat surfaces, not uneven surfaces.
- Regularly inspect the walker for loose or damaged fittings and discontinue use if damaged or broken.
- When not in use the Car Walker should be safely stored away from children.
- The rubber pads on the base should be regularly inspected and cleaned.
- Should the rubber pads become damaged or are no longer lying flat, stop using the Car Walker.
- If the pads are removed, they must be replaced by new pads supplied by Mothercare.
- Only use replacement parts supplied by Mothercare. Others may render the Car Walker unsafe.
- Battery Information:
Batteries should be inserted into the compartments found on the base of the kick pad and the underside of the toy tray.
Do not mix old and new batteries.
Do not mix alkaline, standard (carbon zinc) or rechargeable (nickel-cadmium batteries).
Remove batteries after long periods of non-use.
Battery leakage and corrosion may damage this toy.
Avoid short-circuiting the terminals of the batteries.
Remove exhausted batteries from toys.
Batteries should be inserted with the correct polarity.
Do not use rechargeable batteries.
Non-rechargeable batteries should not be recharged.
Only batteries of the same or equivalent type as recommended should be used.
Batteries must only be changed by an adult.
Rechargeable batteries are only to be charged under adult supervision and rechargeable batteries are to be removed from the toy before being charged.

WARNING! STAIR HAZARD. AVOID SERIOUS INJURY OR DEATH. BLOCK STAIRS/STEPS AND UNEVEN SURFACES BEFORE USING THE WALKER. USE A STAIR GATE AT ALL TIMES.

This walker is intended to be used by children who can sit unaided, approximately from 6 months. It is not intended for children weighing more than 12kg.

- The Car Walker should only be used under adult supervision. NEVER LEAVE YOUR CHILD UNATTENDED.
- Do not use the Car Walker until your child can sit up unaided.
- Use only for limited periods e.g. 20 minutes at a time, as it is not a training aid and excessive use might impair the child's walking development.
- Warning: your child will be able to reach further and move rapidly when in the baby walking frame.
- Prevent collisions with glass in doors, windows and furniture.
- Keep children away from the Walker during set-up and folding and when not in use.
- For indoors use only.
- Open fires, heaters and cooking appliances must be guarded by a nursery type fireguard.
- Remove hot liquids, electrical flexes and other potential hazards from your child's reach.
- Use only on flat surfaces, not uneven surfaces.
- Regularly inspect the walker for loose or damaged fittings and discontinue use if damaged or broken.
- When not in use the Car Walker should be safely stored away from children.
- The rubber pads on the base should be regularly inspected and cleaned.
- Should the rubber pads become damaged or are no longer lying flat, stop using the Car Walker.
- If the pads are removed, they must be replaced by new pads supplied by Mothercare.
- Only use replacement parts supplied by Mothercare. Others may render the Car Walker unsafe.
- Battery Information:
Batteries should be inserted into the compartments found on the base of the kick pad and the underside of the toy tray.
Do not mix old and new batteries.
Do not mix alkaline, standard (carbon zinc) or rechargeable (nickel-cadmium batteries).
Remove batteries after long periods of non-use.
Battery leakage and corrosion may damage this toy.
Avoid short-circuiting the terminals of the batteries.
Remove exhausted batteries from toys.
Batteries should be inserted with the correct polarity.
Do not use rechargeable batteries.
Non-rechargeable batteries should not be recharged.
Only batteries of the same or equivalent type as recommended should be used.
Batteries must only be changed by an adult.
Rechargeable batteries are only to be charged under adult supervision and rechargeable batteries are to be removed from the toy before being charged.