



IMPORTANT!

You must ensure that you follow these instructions carefully and correctly. If this seat is not fitted securely and your child is not strapped in correctly, your child and other passengers are at serious risk of injury in the event of an accident

Please read this User Guide carefully BEFORE trying to install your child car seat

The Hampshire Trading Standards Authority and Britax advise that child car seats should not be bought or sold second-hand. Please dispose of your child seat safely. Do not sell or pass it on.

After an accident, the child seat and your car seat belts should be replaced. Although they may look undamaged, if you were to have another accident the child seat and your car seat belts may not be able to protect your child as well as they should.

No child seat is escape proof

Harness systems cannot be designed to be completely "child proof" and yet comply with the legal requirements of European Standard ECE R44. The harness must be fastened and adjusted correctly at all times and children encouraged to remain within the harness system.

Looking after your child seat

Food and drink may find their way inside the buckle of the harness. This can stop it from working properly – it will not click. Wash in warm water until clean (dia A and B).

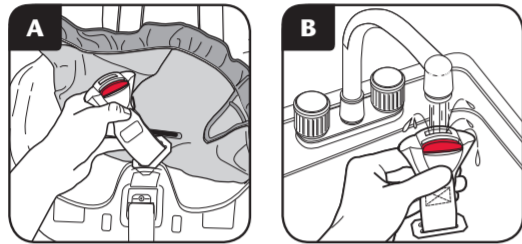

Cleaning the cover

Please read the labels on the cover for washing instructions.

DO NOT tumble dry the cover – short spin and drip dry only.

Cleaning the harness and seat shell

Sponge clean **ONLY** using hand soap and warm water.

DO NOT take apart, or attempt to take apart, any part of the harness or seat when cleaning.

DO NOT use solvents, detergents or washing-up liquid as these may weaken the harness and the seat.

DO NOT lubricate or oil any part of the seat.

Removing and refitting the cover

Press in and hold the harness release button and with your hand below the chest pads (dia 1a, overleaf) pull **BOTH** shoulder straps forwards as far as they will go. Pull up on the shoulder straps at the back of the seat to lift the yoke from behind the belt shield. Unhook both shoulder straps from the yoke and unhook both chest pads from the harness height adjuster.

Pull the cover from the top of the seat and bring the straps through the shell to the front of the seat and remove the chest pads. Unfasten the buckle and remove the comfort pad by unfastening the hook and eye strip. Gently pull the cover off the seat, easing the shoulder straps adjuster, shoulder straps, and harness buckle and adjuster strap through the slots in the cover. To refit the cover, reverse this method of removal. Make sure the straps are not twisted when refitting through the cover and on to the yoke.

IMPORTANT – The cover is a safety feature. **NEVER** use the child seat without it. Don't put your child's safety at risk by using other makes of replacement cover, they could stop the child seat from protecting your child as well as it should.

A replacement cover is available from your Britax stockist or contact Britax Customer Service Department on 01264 386034.

Guarantee

All Britax products are carefully designed, manufactured and tested. However, should this product prove faulty within 12 months of purchase due to a materials or manufacturing fault please return it to the original place of purchase. We will then, at our discretion, either repair it free of charge or replace it with the same or a similar product.

For guarantee purposes proof of purchase will be required. We recommend that you retain your receipt and attach it to this user guide. They should be kept in a safe place.

Britax does not accept liability for damage arising from abuse, misuse or negligence. This guarantee is not transferable and therefore does not apply to second-hand products.

Your statutory rights are not affected by this guarantee.

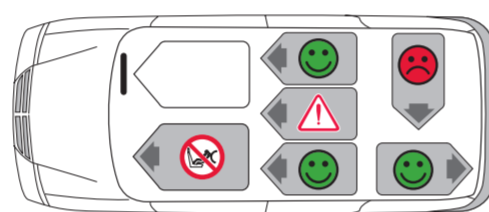

If in doubt

Not all car seats fit all cars. For advice as to the suitability of this restraint for your car please use **Fit-finder** on our website at www.britax.eu, call our Customer Service Helpline on 01264 386034 or email helpline@uk.britaxeurope.com.

WARNING

EXTREME HAZARD!



DO NOT use the child seat on a passenger seat fitted with an active front airbag unless your vehicle manufacturer confirms that it is safe.

DO NOT use anything, such as a cushion or coat, to raise the child seat off the passenger seat. In an accident the child seat and your car seat belts would not be able to protect your child as well as they should.

DO NOT use the child seat in the home. It has not been designed for home use and should only be used in your car.

DO NOT attempt to dismantle, modify or add to any part of the child seat or change the way its harness or your car seat belts are made or used. The official approval is no longer valid if modifications are made. **NO** modifications may be made to the child seat other than by the manufacturer.

DO NOT leave children alone in your car, even for a short time.

DO NOT leave loose objects, such as luggage or books, in the back of your car. They must be properly secured, because if you have to stop your car suddenly loose objects will keep moving and can then cause serious injuries. Large and heavy loose objects are a particular risk.

DO NOT leave folding passenger seats unlatched. If you have to stop your car suddenly a loose seat back could injure your child.

DO NOT allow children to play with or adjust the child seat.

DO keep this user guide in the user guide storage pocket.

DO cover the child seat if your car is left in direct sunlight. Fittings can become hot to touch in sunny weather and the cover may become faded.

DO make sure that the child seat does not become trapped by a folding passenger seat or in the door of your car.

DO make sure that you adjust the harness to fit the clothes your child is wearing before each journey – a fitting for winter clothes may be too slack for a child wearing summer clothes.

DO store the child seat in a safe place when it is not being used. Avoid placing heavy objects on top of it and do not store near direct heat sources or in direct sunlight.

DO always keep the child seat secure, even if it is not being used by your child.

DO make sure that all occupants in the vehicle are correctly restrained.

DO where necessary, use the insertion guides when installing the child seat with ISOFIX fittings. Failure to do so may result in damage to your vehicle seat.



IMPORTANT – ISOFIX should only be used with vehicles which appear on the supplied applications list. An up-to-date copy of the list can also be found on the Britax website – www.britax.co.uk

Britax, whilst taking into account child car seat contact with vehicle seats throughout the development of new products, cannot accept responsibility for damage occurring to vehicle seats or seat belts.



IMPORTANT – The child seat **MUST** only be used with ISOFIX (see application list) or a lap and diagonal seat belt (approved to UN/ECE Regulation no. 16 or other equivalent standards).

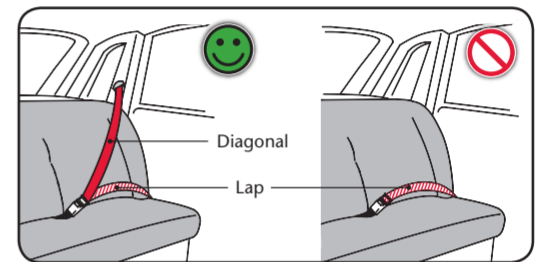

Britax Excelsior Limited

1 Churchill Way West
Andover
Hampshire SP10 3UW
United Kingdom

A Britax Childcare company

Customer Service Helpline: 01264 386034
Email: helpline@uk.britaxeurope.com
Switchboard: 01264 333343
Fax: 01264 334146
www.britax.eu

Introducing your new child car seat

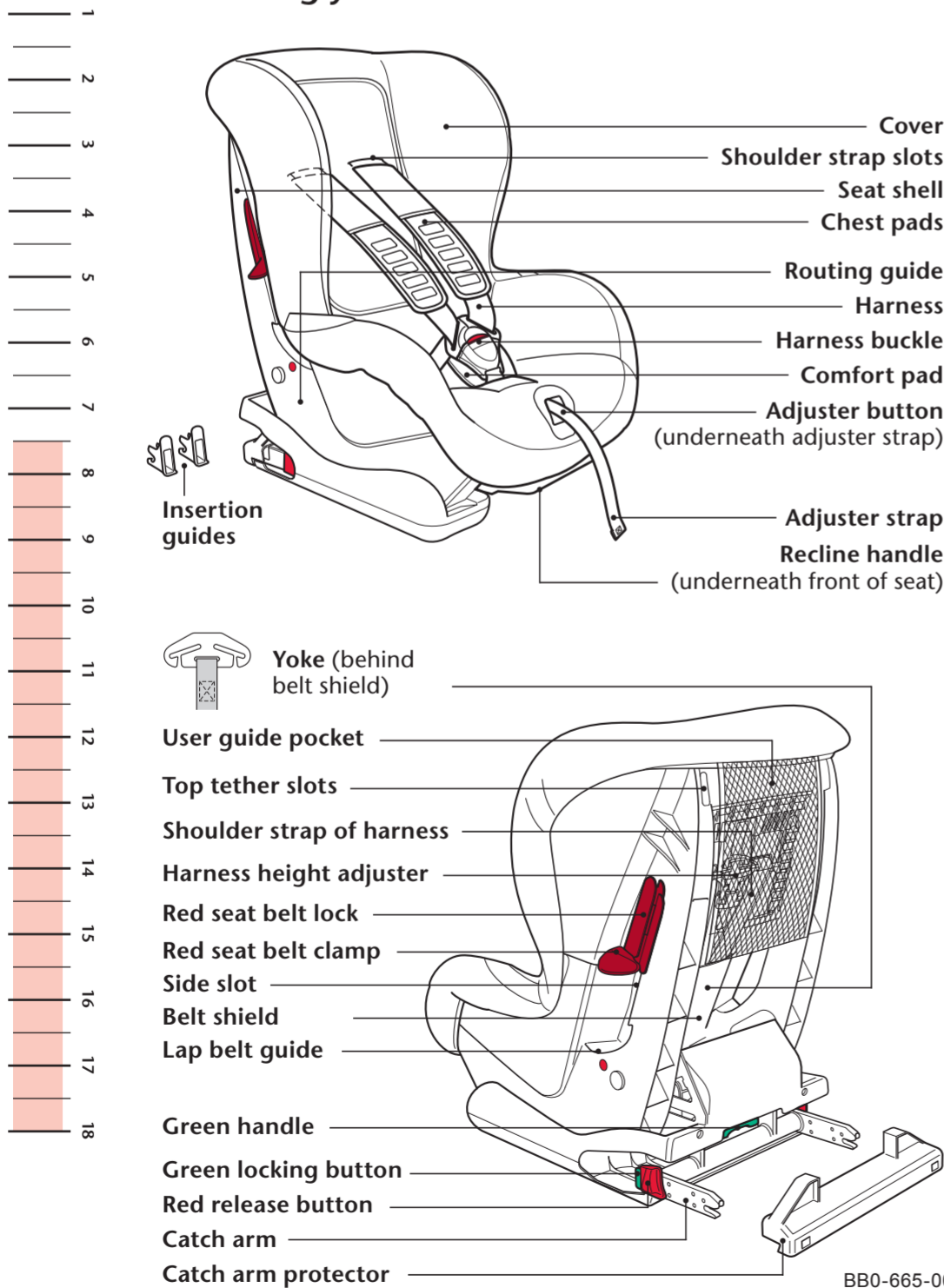

BB0-665-00 1/8



Britax

GB User Guide
9-18Kg (Group 1)

Duo Plus ISOFIX

1. Adjusting the child seat Children weighing 9-18kg (approx 9 months to 4 years)

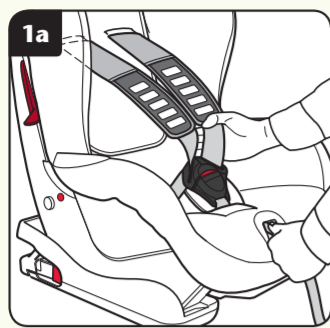

IMPORTANT – You must adjust the height of the shoulder straps to the correct position for your child **BEFORE** installing the child seat, as they cannot be adjusted once installed in the car.

Harness adjustment
With one hand press the adjuster button and with your other hand **BELOW** the chest pads, pull both shoulder straps forward as far as possible to loosen the harness (**dia 1a**).

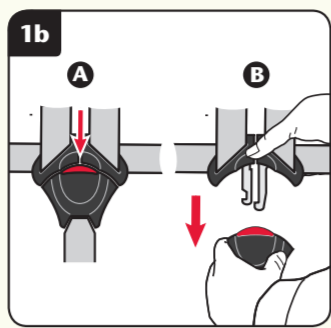

Unfasten the buckle by pressing the red harness buckle button **A** (**dia 1b**). Fit the harness around your child. To fasten the buckle; first fit the two upper sections together, then push them firmly into the lower section until you hear a positive click **B**.



Adjusting the harness
The shoulder strap slots in the cover and shell **MUST** be level with the top of your child's shoulders. If in any doubt always position the slots slightly above the shoulder rather than below it (**dia 1c**). However, once you reach the top position your child may continue to use the seat until their eye line is above the top of the seat shell or their weight exceeds 18kg.

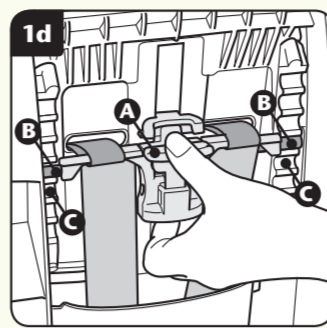

Place your hand on the harness height adjuster and with your thumb, squeeze the adjuster tab **A** (**dia 1d**). The top of the adjuster can now pivot outwards, releasing the bar **B** from the adjuster notches **C**. Now move the adjuster up or down to an appropriate height for your child. Pull the adjuster strap to remove any excess slack. Re-try your child in the seat.

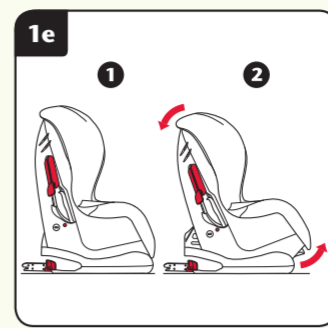

To tighten the harness
With your child in the seat and the harness fastened, check that the harness is not twisted and pull the shoulder straps up to tighten the lap section of the harness. Then tighten the harness by pulling the adjuster strap forward making sure the harness is a comfortable but **FIRM** fit around your child.

Reclining the child seat
The child seat has a choice of three recline positions for your child's comfort. It can be used in either an upright position **1**, reclined or sleeping position **2** (**dia 1e**). Squeeze the recline handle, underneath the front of the child seat, and slide the child seat shell into the desired position.

IMPORTANT – Each time you adjust the child seat check that it is still secure and that the seat belt/top tether is tight, if fitted.

2. Installing the child seat in your car using the ISOFIX fittings

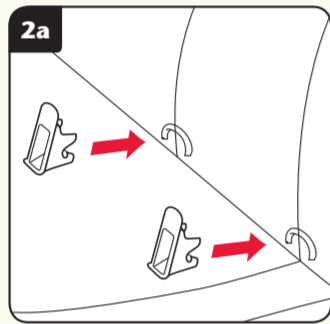

IMPORTANT – The child seat has been specific-vehicle approved. For advice as to the suitability of the child seat for your car and if it has to be installed with a top tether or requires an additional performance pad, please call our Customer Service Helpline on **01264 386034**, visit www.britax.eu, or refer to the applications list. The top tether kit and performance pad are available from your Britax stockist. A fitting guide is supplied with the tether kit.

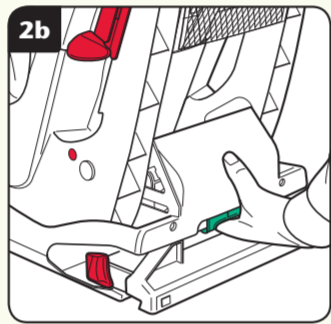

Installing the child seat
If required, clip the two insertion guides onto the two ISOFIX anchorage points on the vehicle seat (between seat and backrest). The cut out on the insertion guide must point upwards (**dia 2a**). The insertion guides should be removed when not in use and can be stored in the user guide pocket. Pull the green handle at the base on the back of the seat out to extend the two catch arms fully (**dia 2b**).

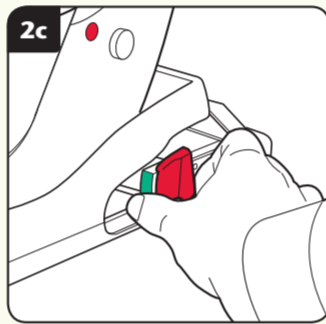

To release the catch arm protector, hold in the green locking button whilst squeezing the red button on one side of the seat (**dia 2c**). Repeat for the other side. Remove the catch arm protector and store it in a safe place. With the child seat on the car seat in the upright position (not reclined), guide the two catch arms

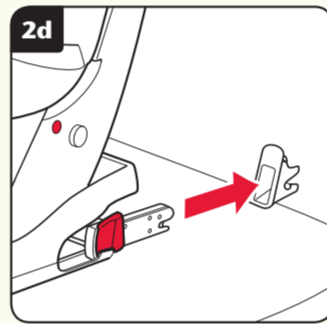

into the insertion guides (**dia 2d**). Place your thumb on the green locking button and press in firmly until you feel the system latch. Ensure that you feel and hear the locks engage (click) and that the green button on the catch arm has extended. Repeat for the other side of the seat (**dia 2e**). Firmly push the side arms of the child seat into the vehicle seat, applying even pressure on both sides, to ensure it is latched in fully

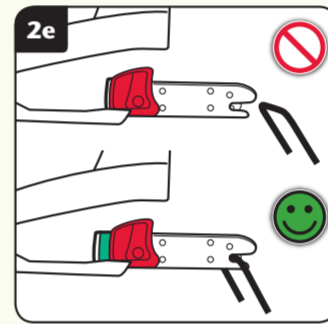

on each side (**dia 2f**). The seat should now be secure. To check, pull forward firmly on the harness. There should be little or no movement. **IMPORTANT** – Ensure that the child seat is latched correctly every time you use it and that the green locking button is visible on both sides. **Removing the child seat from your car**
To release the ISOFIX fixings, hold in the green locking button whilst

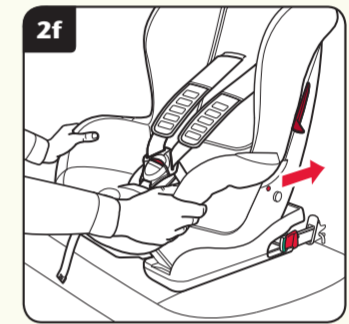

squeezing the red button on one side of the seat. Repeat for the other side. To release the top tether anchoring, loosen the strap by lifting the metal tongue of the adjuster and remove the spring hook from the anchoring point. Finally, remove the insertion guides from the vehicle seat. If in any doubt contact our Customer Service Helpline on **01264 386034**.

3. Installing the child seat in your car with a lap and diagonal seat belt

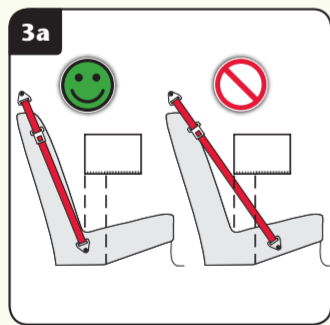

Forward Anchorages
The child seat can be securely fitted in many cars using the lap and diagonal seat belt. However, some types of car designs prevent you from making a good installation due to the position of the seat belt lower anchorage points (the point where your seat belt and buckle are attached to the vehicle). Put the ruler printed on the front of this user guide on your car seat in the position shown (**dia 3a**). Now decide if both of the lower anchorage points are in line with the white or red area of

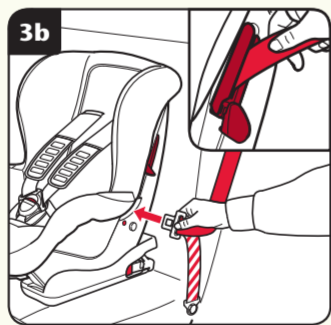

the ruler. If they are in the white area then you can use this position for the child seat. If either of the lower anchorage points are in the red area then you should try the child seat in another position in the car. **IMPORTANT** – The child seat **MUST** only be installed using a lap and diagonal seat belt routed as shown. The child seat should **NEVER** be fitted using a lap belt only. **IMPORTANT** – Ensure that the ISOFIX catch arms are within the base of the seat and that the catch arm protector is fitted.

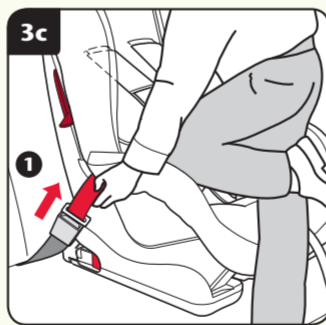

With the child seat on the car seat in the upright position (not reclined), pass the seat belt through both side slots. Fasten the seat belt, making sure it is not twisted. Before going any further make sure that the lap section of the seat belt passes below both lap belt guides (**dia 3b**). Swivel the seat belt clamp down and thread the diagonal section of the seat belt through the seat belt lock (**dia 3b inset**). **IMPORTANT** – The child seat has two red seat belt locks. Only use the one **FURTHEST** away from the seat belt buckle.

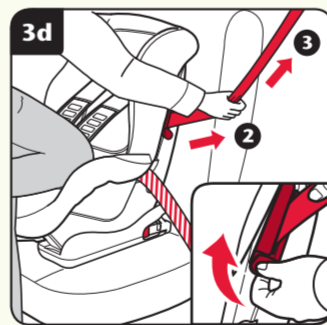

Firmly, push the child seat into the car seat, using your body weight (**dia 3c**). Pull the seat belt to tighten the lap section **1** (**dia 3c**), and then pull the diagonal section of the seat belt tight **2**, keep pulling the diagonal section of the seat belt **3** (**dia 3d**), as you swivel the seat belt clamp upwards until it engages (**dia 3d inset**). The child seat should now be secure. To check pull forward firmly on the harness. There should be little or no movement.

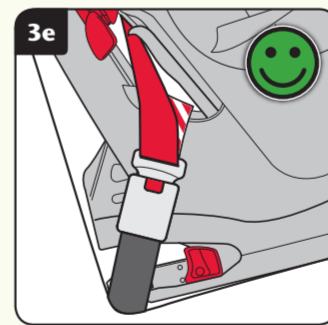

IMPORTANT – After installing the child seat you need to check the position of the seat belt buckle. **Checking the position of the seat belt buckle**
If, after following the installation instructions, your seat belt buckle looks like this (**dia 3e**) the child seat should now be secure. To check this try to pull the seat forward by the harness. It should feel firm, not loose.

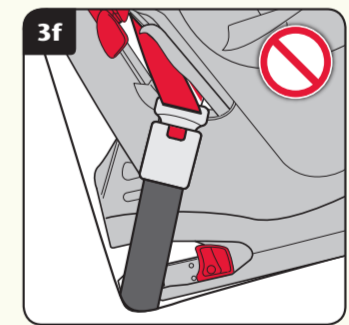

If, after following the above instructions, your seat belt buckle looks like this (**dia 3f**) the child seat is **NOT** correctly installed. Try another seating position in your car. If you are in any doubt contact Customer Services on **01264 386034**. To remove the car seat from the car simply unfasten the seat belt.